



**KEYSTONE**  
CENTRE

**Technical Package**

# Address, Building, and Contact Information

**Mailing and Physical Address:** Keystone Centre  
#1-1175 18<sup>th</sup> Street  
Brandon, MB, R7A 7C5  
204.726.3500 MAIN  
204.727.5552 FAX

The original Keystone Centre opened its doors in 1972, the product of a joint venture between the City of Brandon, the Government of Manitoba, the Provincial Exhibition of Manitoba (the Fair) and private donors. The Keystone Agricultural and Recreation Centre Inc. is a freestanding non-profit corporation that owns and operates the 90 acres of property and of the buildings known as the Keystone Centre. Today the Keystone Centre sits in Brandon's busiest commercial district, offers 540,000 square feet of concerts, 6,000 for meetings, 5,400 for sporting events, and 2,800 for banquets, the Keystone Centre is truly a versatile and multi-functional venue, capable of hosting world class events.

## **Contacting the Keystone Centre:**

<b>CEO &amp; General Manager</b>	<b>Connie Lawrence</b> 204.729.3752 <a href="mailto:connie@keystonecentre.com">connie@keystonecentre.com</a>
<b>Sales Manager</b>	<b>Julie Shiloff</b> 204.726.3502 <a href="mailto:julie@keystonecentre.com">julie@keystonecentre.com</a>
<b>Ice Bookings</b>	<b>Sarah Clarkson</b> 204.726.3506 <a href="mailto:sarah@keystonecentre.com">sarah@keystonecentre.com</a>
<b>Director of Events</b>	<b>Adam Cudal</b> 204.726.3523 <a href="mailto:adam@keystonecentre.com">adam@keystonecentre.com</a>
<b>Director of Operations</b>	<b>Steven Gabriel</b> 204.726.3505 <a href="mailto:steven@keystonecentre.com">steven@keystonecentre.com</a>
<b>Ag Manager</b>	<b>Devin Epp</b> 204.726.3556 <a href="mailto:devin@keystonecentre.com">devin@keystonecentre.com</a>
<b>Director of Ticketing</b>	<b>Jared McKenzie</b> 204.726.3534 <a href="mailto:jared@keystonecentre.com">jared@keystonecentre.com</a>

For General Info: 204.726.3500, Online Information: [www.keystonecentre.com](http://www.keystonecentre.com)

# Facility Maps



# Loading In, Parking, and Directions

**Loading Door(s):** Multiple loading doors based on the location of your event. Contact sales or Event Manager for loading door use. (Refer to Maps on pg. 6)

**Parking and Delivery Access:** Access to the loading door and parking needs to be arranged with the Sales Manager.

## **Directions:**

### **FROM WINNIPEG, MB: (Approx. 2hr drive time)**

Head West to Trans-Canada Hwy/MB-1W, turn left onto MB 110S, turn right onto Richmond Ave E, turn right onto MB 10N (18<sup>th</sup> Street), and the Keystone Centre will be on your right.

### **FROM REGINA, SK: (Approx. 3.5 hr drive time)**

Head East to Trans-Canada Hwy/SK-1E, to Trans-Canada/MB 1AE, turn right onto 18<sup>th</sup> Street/MB-10N, and the Keystone Centre will be on your left.

### **FROM MINNIAPOLIS, MN (Approx. 9hr drive time)**

Follow 1-94 W, take exit 349B to merge onto I-29N/US-81 N towards Grand Forks, continue straight on MB-75N, keep left to continue on Lord Selkirk Hwy/MB75N, turn left onto Boyne Ave W/MB-23W, turn right onto Provincial Truck Hwy 34N (Signs for Brandon), and the Keystone Centre will on your right.

### **FROM MINOT, ND: (Approx. 3hr drive time)**

Head North on US-38N, turn right onto ND-5E/US-83N, continue straight on ND-5E, turn left onto ND-14N, continue on Provincial Trunk Hwy 21N, turn right onto the MB-23E (Signs for Elgin), turn left onto MB-10N (Signs for Brandon), and the Keystone Centre will be on your right.

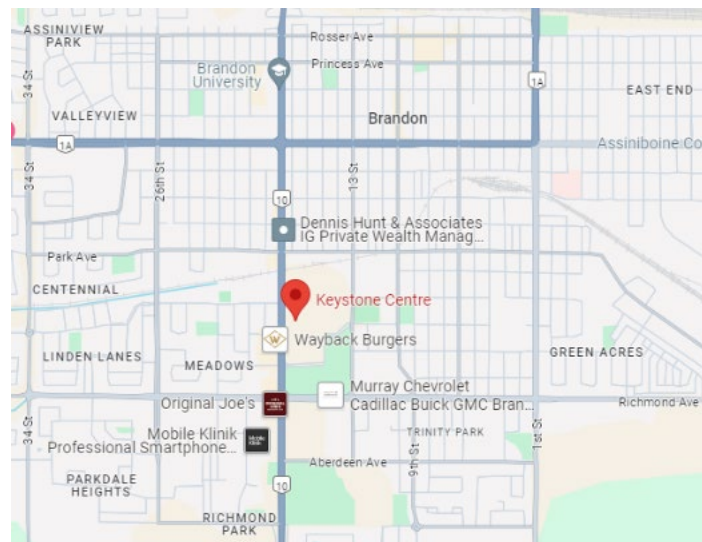

# Loading Door Map

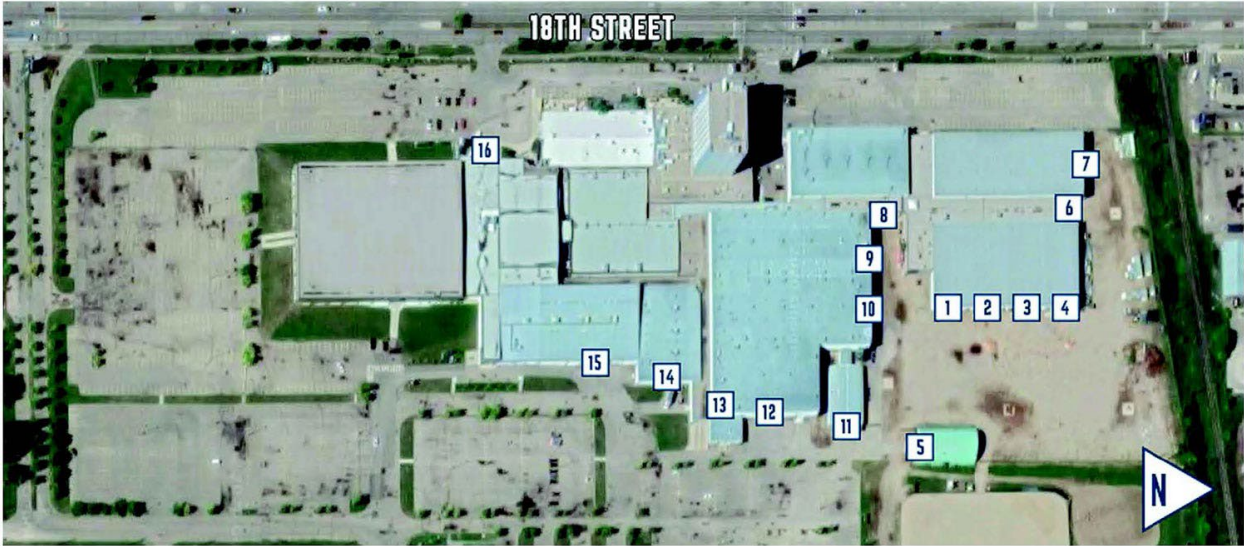

# Parking Lot Map

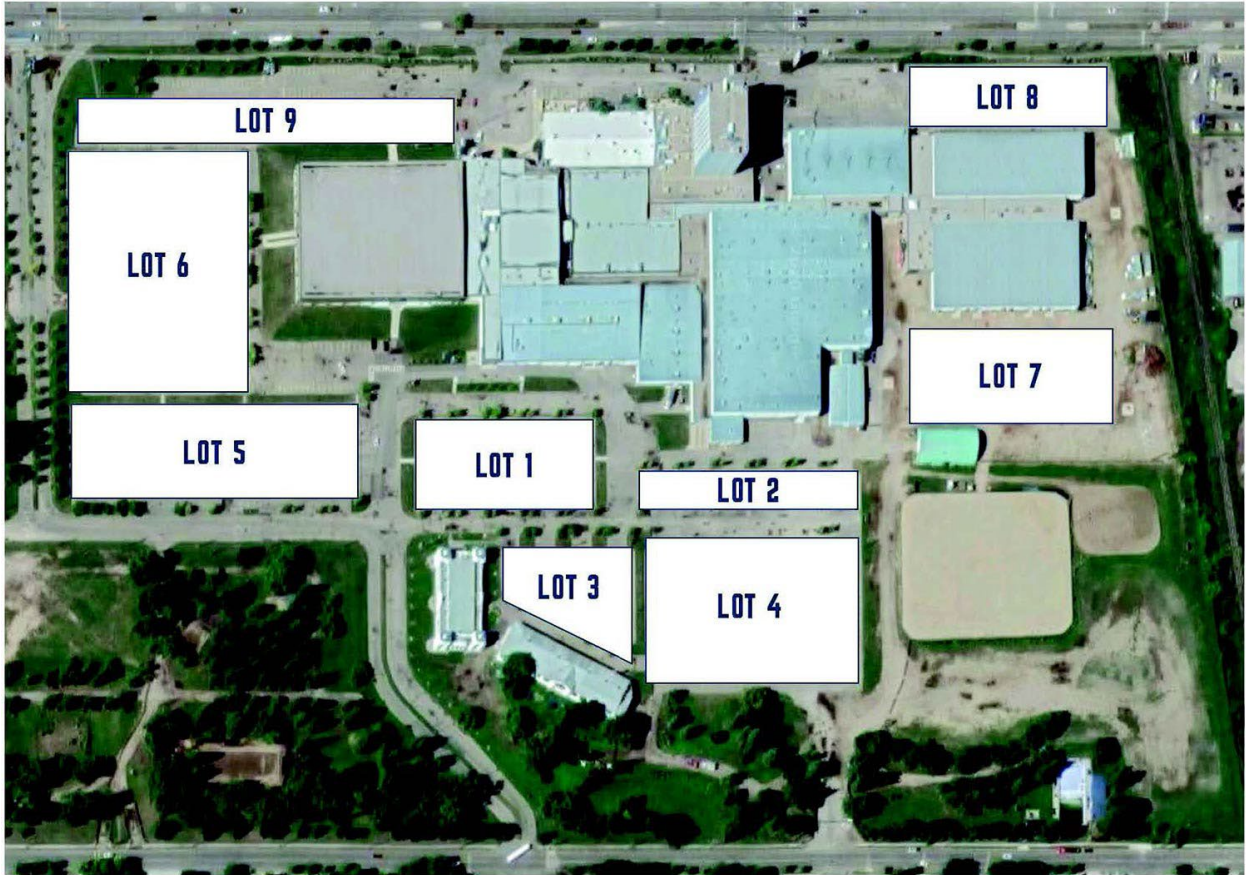

# Assembly Hall

## **Room Details:**

Dimensions: 39 ft x 44 ft (17,16 ft<sup>2</sup>)

Location: Upper Level

Ceiling: 9 ft 6 in

Flooring: Carpet

## **Convention:**

Theatre Seating: 125 Approx

Banquet Seating: 90 Approx

Entrances: Double Doors (2)

Lighting: Fluorescent – on/off switches, dimmable pot light switches

Audio/Visual:

Fixed ceiling hung projector

HDMI & VGA input (1 ea.) (West Wall)

Fixed pull down screen (West Wall)

XLR inputs (2) (West & South Wall)

Fixed hour speakers (linkable with Viewing Lounge)

## **Features:**

Fireplace: Gas-adjustable

Washrooms: Men's & Women's

Bar Window: Shared bar with Viewing Lounge

Room Divider: Opens into the Viewing Lounge

Window: Overlooks Assiniboine Credit Union Place (South Wall)

# Viewing Lounge

## **Room Details:**

Dimensions: 30 ft x 44 ft (1,320 ft<sup>2</sup>)

Location: Upper Level

Ceiling: 9 ft 10 in

Flooring: Carpet

## **Convention:**

Theatre Seating: 70 Approx

Banquet Seating: 60 Approx

Entrances: Double Doors (1)

Lighting: Fluorescent – on/off switches, dimmable pot light switches

Audio/Visual:

Fixed TV (East Wall)

XLR inputs (1) (West Wall)

Fixed house speakers (Linkable with Assembly Hall)

## **Features:**

Washrooms: Men's & Women's

Bar Window: Shared bar with Assembly Hall

Room Divider: Opens into the Assembly Hall

Coat Rack: Fixed (inside main entrance)

Lower Viewing Level: 10 Bar stools and 5 cocktail tables

Window: Overlooks Assiniboine Credit Union Place (South Wall)

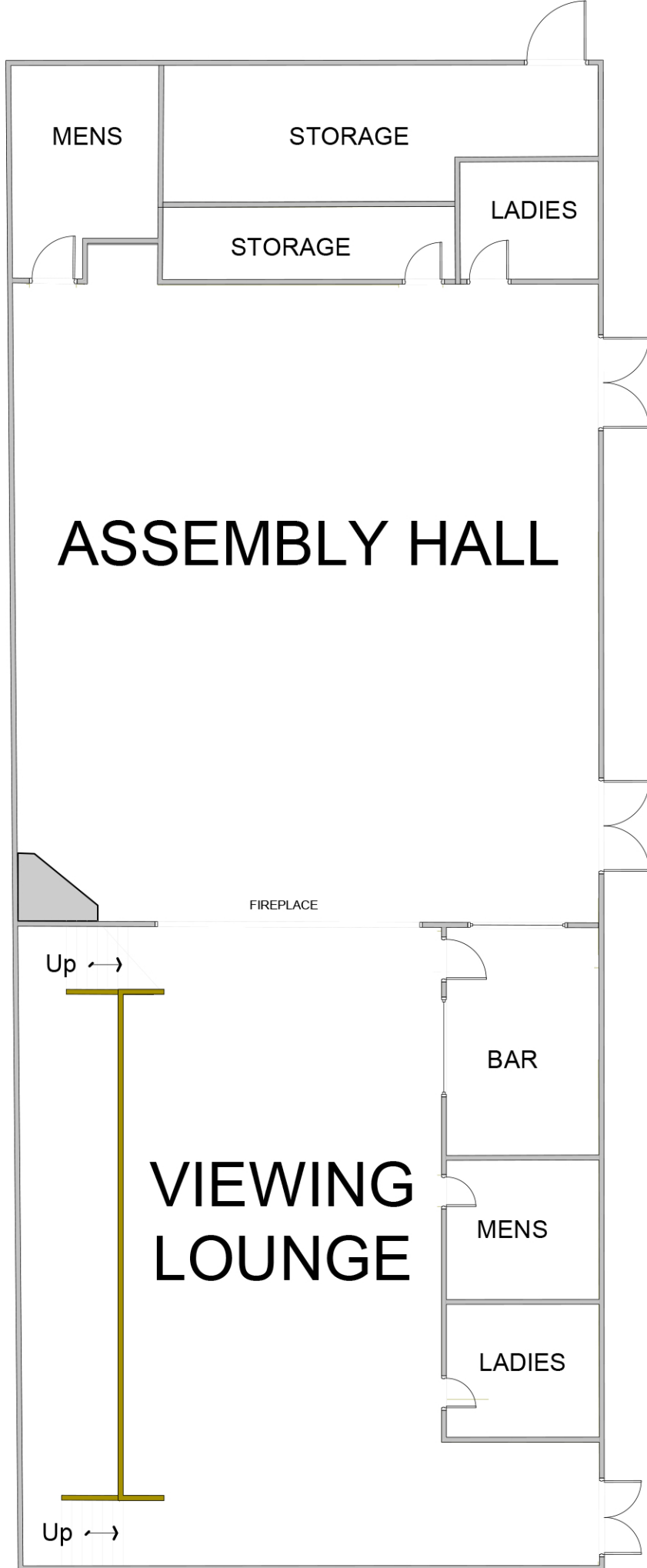

MENS

STORAGE

STORAGE

LADIES

ASSEMBLY HALL

FIREPLACE

Up ↔

BAR

VIEWING LOUNGE

MENS

LADIES

Up ↔

# Pioneer Lounge

## **Room Details:**

Dimensions: 33 ft x 55 ft (1,815 ft<sup>2</sup>)  
Location: Upper Level  
Ceiling: 8 ft 10 in  
Flooring: Carpet

## **Convention:**

Theatre Seating: 130 Approx  
Banquet Seating: 96 Approx  
Entrances: Double Doors (2)  
Lighting: Fluorescent – on/off switch

### Audio/Visual:

- Fixed ceiling hung projector
- HDMI & VGA input (East Wall)
- Fixed pull-down screen (East Wall)
- XLR inputs (2)
- Fixed house speakers

## **Features:**

Washrooms: Men's & Women's  
Window: Overlooks Manitoba Room (North Wall)

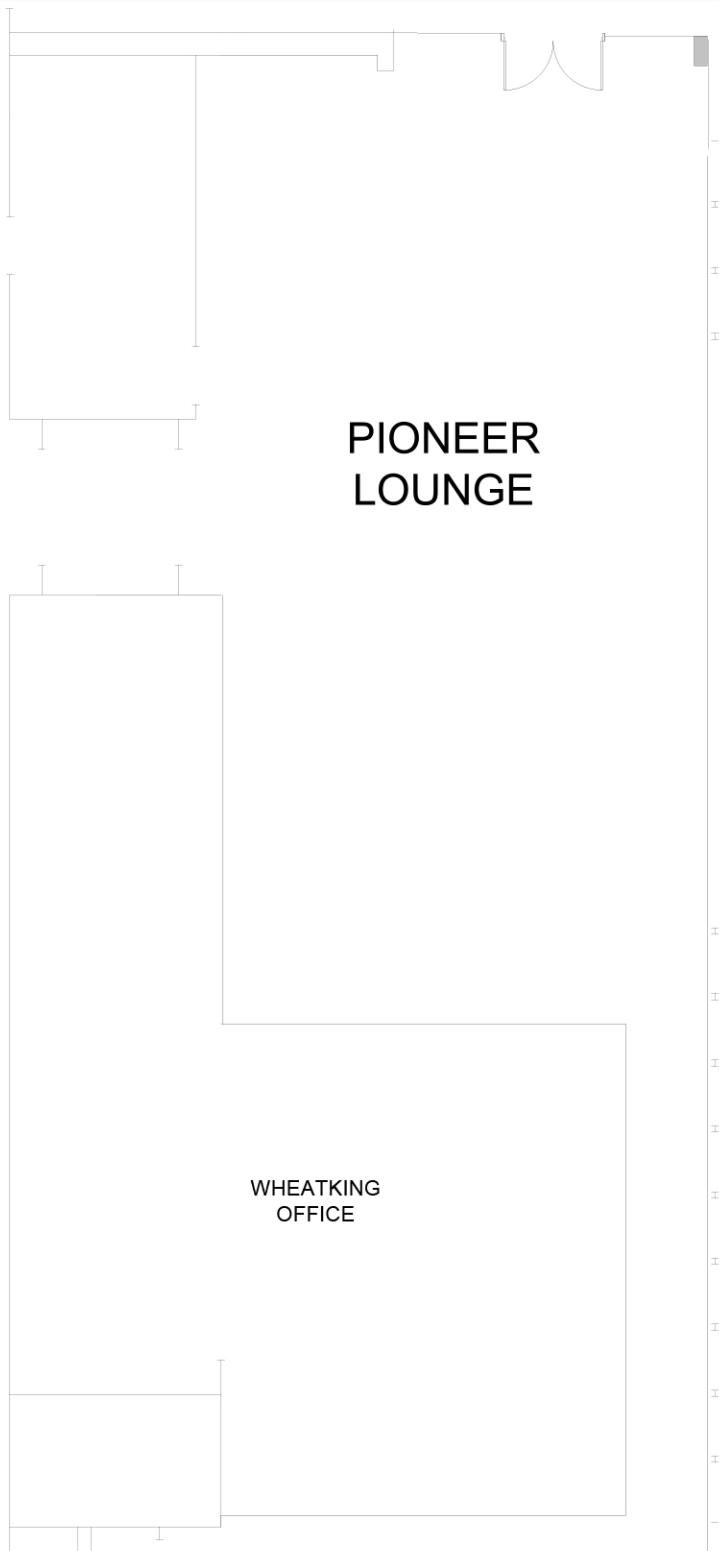

PIONEER  
LOUNGE

WHEATKING  
OFFICE

# MNP Hall A & B (Half room)

## **Room Details:**

Dimensions: 91 ft x 49 ft (4,459 ft<sup>2</sup>)

Location: Upper Level

Ceiling: 13 ft 6 in

Flooring: Laminate

## **Convention:**

Theatre Seating: 200 Approx

Banquet Seating: 150 Approx

Entrances: Double Doors (1), Single Doors (1)

Lighting: Fluorescent-row switches, dimmable pot light switches

## **Audio/Visual:**

Fixed ceiling hung projectors (1) (A: NW corner & B: NE corner)

Fixed pull-down screens (1) (A: NW corner & B: NE corner)

HDMI & AUX inputs (2) (A: West Wall & B: North Wall)

XLR inputs (6) (3 each) (A: West & North Wall & B: East & North Wall)

Fixed house speakers

## **Features:**

Room Divider: Splits the room in half (MNP A: West & East)

Sectioned wall divider allow pass through (7 ft 11 in Main Lobby)

# MNP Hall (Full Room)

## Room Details:

Dimensions: 91 ft x 86 ft (7,826 ft<sup>2</sup>)

Location: Upper Level

Ceiling: 13 ft 4 in

## Convention:

Theatre Seating: 650 Approx

Banquet Seating: 380 Approx

Entrances: Double Doors (2), Single Doors (2)

Lighting: Fluorescent-row switches, dimmable pot light switches

Audio/Visual:

Fixed ceiling hung projectors (2) (NW & NE corners, linkable via NW input)

Fixed pull-down screens (2) (NW & NE corners)

HDMI & AUX input (2) (West & North Wall)

XLR inputs (6) (East, West & North Wall)

Fixed house speakers (able to separate between the 2 sides)

## Features:

Room Divider: Splits the room in half (MNP A: West & MNP B: East)

Sectioned wall divider allow pass through (7 ft 11 in, each panel)

Washrooms: Men's & Women's

# MNP HALL A

S  
T  
O  
R  
A  
G  
E

# MNP HALL B

S  
T  
O  
R  
A  
G  
E

S  
T  
O  
R  
A  
G  
E

MEN'S  
BATHROOM

BREEZEWAY

KITCHEN



# Amphitheatre

## Room Details:

Dimensions: 64 ft x 105 ft (6,720 ft<sup>2</sup>)  
Location: Upper Level  
Ceiling: 11 ft (Upper) 24 ft 7 in (Stage level)  
Flooring: Carpet

## Convention:

Fixed seating: 569 (Including 25 wheelchair accessible seating)  
Entrances: Double Doors (3)  
Lighting: Fluorescent-row switches  
Audio/Visual:  
    Fixed ceiling hung projector (West Wall)  
    VGA & AUX inputs (East Wall on ground level)  
    Fixed screen (East Wall)  
    XLR inputs (5) (East Wall on ground level)  
    Fixed screen (East Wall)  
    XLR inputs (5) (East Wall on ground level)  
    Fixed house speakers

## Features:

Semi-circle center stage: 28 ft x 30 ft ground level  
Loading overhead door: 21 ft 11 in x 10 ft  
Stage right & left exits: Stage right exit via ramp, Stage left exit via stairs  
Washrooms: Men's and Women's (Located outside Amphitheatre on Main Lobby)

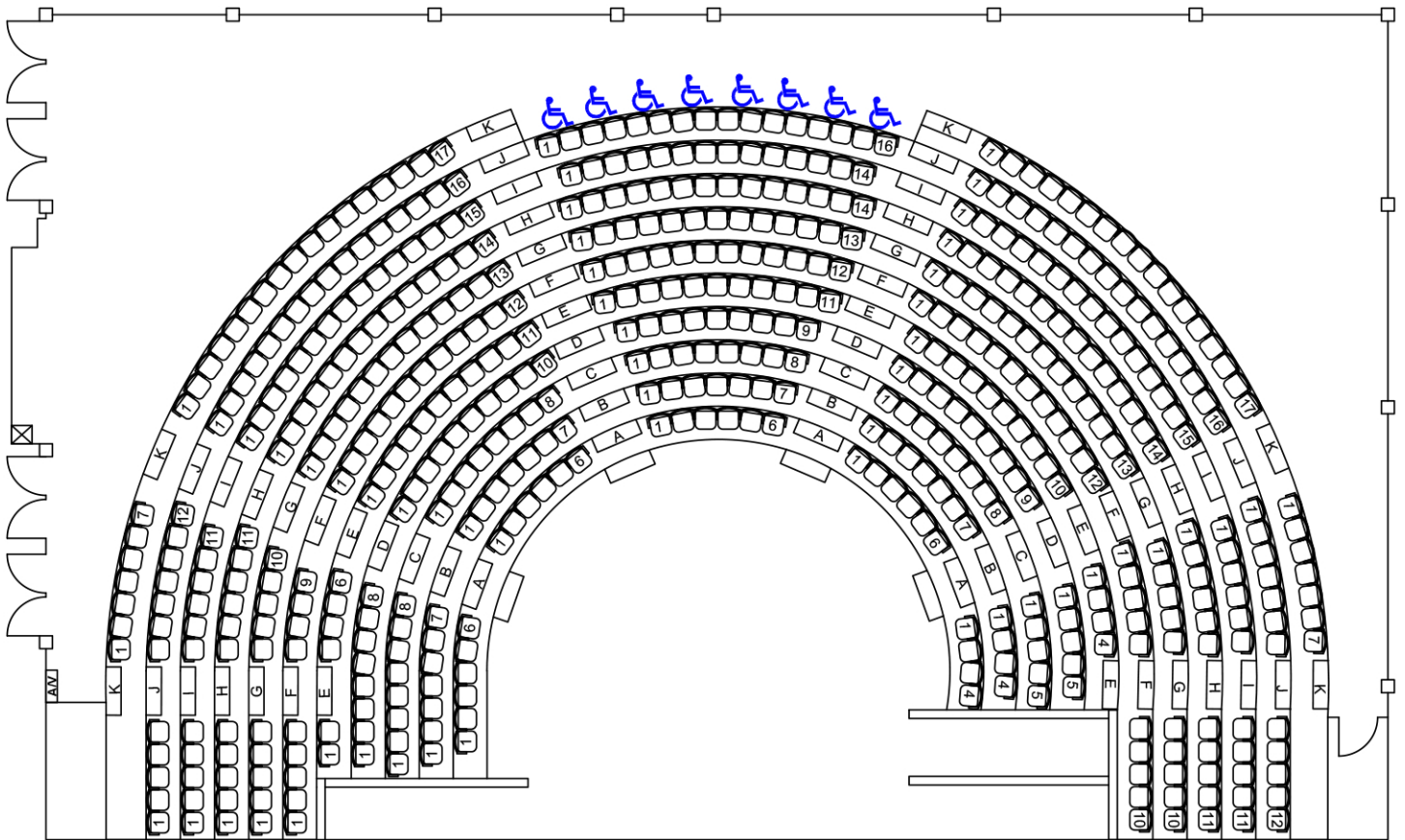

# Manitoba Room

## **Room Details:**

Dimensions: 125 ft x 200 ft (25,000 ft<sup>2</sup>)

Location: Lower Level

Ceiling: 17 ft 2 in (Low/East), 22 ft 6 in (Middle), 27 ft (High/West)

Flooring: Concrete

## **Convention:**

Theatre Seating: 2500 Approx

Banquet Seating: 1500 Approx

Concert Seating: 1700 Approx

Tradeshow Booths: 131 Approx

Entrances: Double Doors (4, Interior), Single Doors (10, Exterior)

Lighting: LED-row switches

Audio/Visual:

XLR inputs (6)

Fixed house speakers (linkable with all lower level rooms)

## **Agricultural Specs:**

Stalling: 123 (10 ft x 10 ft)

## **Features:**

Loading Overhead Door: 22 ft x 15 ft 6 in (East)

Connecting Overhead Door: 12 ft x 17 ft 5 in

Office Space: 10 ft x 11 ft (South Wall, Glass windows)

Washrooms: Men's & Women's

(South set of washrooms shared with UCT Pavilion)

# MANITOBA ROOM

MENS & WOMENS

OFFICE

MENS & WOMENS

STORAGE



# UCT Pavilion

## **Room Details:**

Dimensions: 83 ft x 167 ft (13,861 ft<sup>2</sup>)  
Alcove: 24 ft x 51 ft (1,224 ft<sup>2</sup>)  
Location: Lower Level  
Ceiling: 12 ft 9 in (Lowest), 13 ft 9 in (Highest)  
Flooring: Tile

## **Convention:**

Theatre Seating: 1120 Approx  
Banquet Seating: 600 Approx  
Tradeshow Booths: 56 Approx (10 x 10)  
Entrances: Double Doors (7)  
Lighting: LED-row switches, independent stage lights (North Centre)  
Audio/Visual:  
    XLR inputs (4)  
    Fixed house speakers (Linkable with all lower level rooms)

## **Features:**

Loading Overhead Door: 10 ft x 10 ft (East)  
Connecting Overhead Door: Opens into Manitoba Room  
Washrooms: Men's & Women's (Shared with Manitoba Room)  
Alcove Area: Separate light switches

# UCT PAVILLION

MENS &  
WOMENS

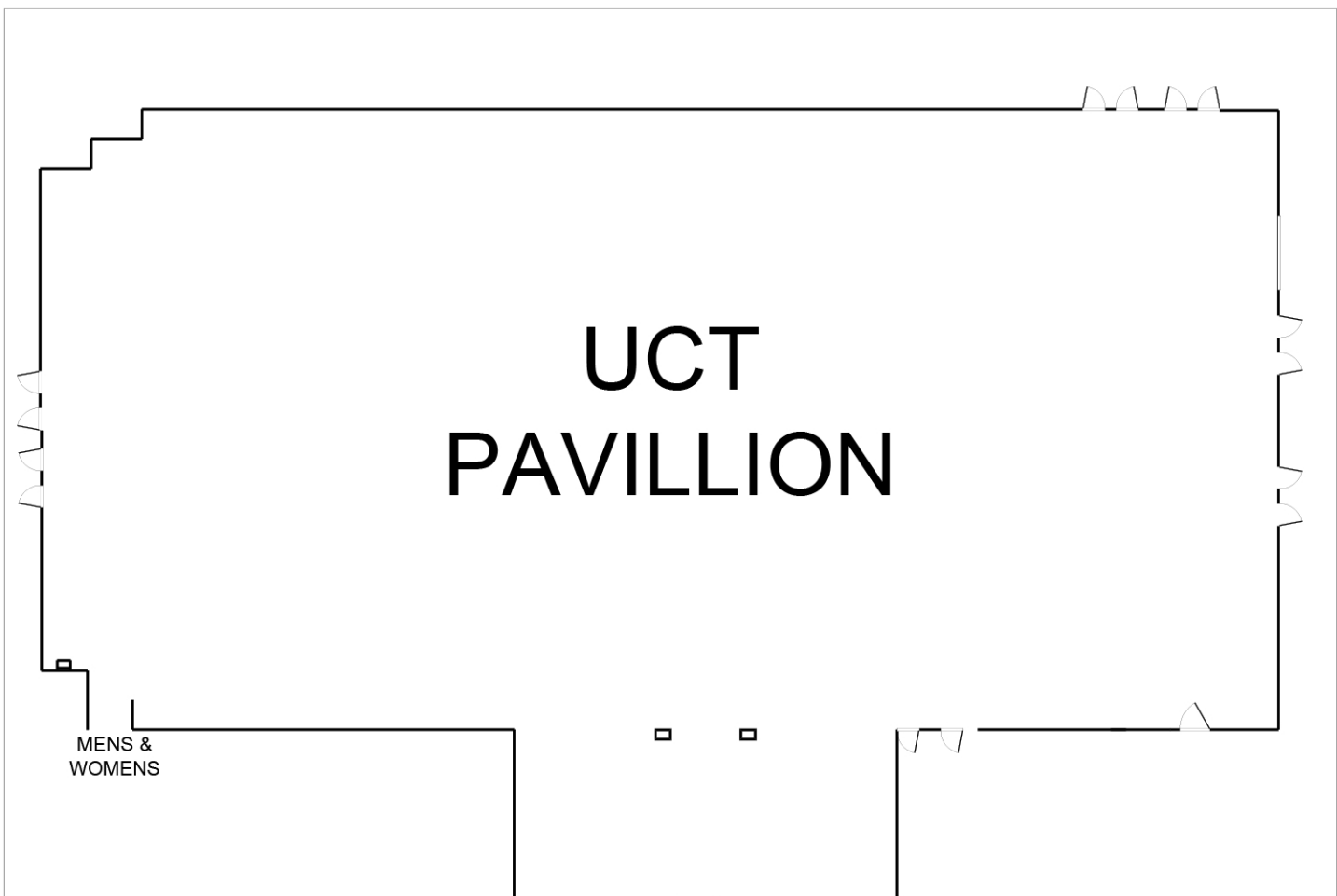

# City Square

**Room Details:**

Dimensions: 190 ft x 84 ft (15,960 ft<sup>2</sup>)

Location: Lower Level

Ceiling: 14 ft 4 in

Flooring: Concrete

**Convention:**

Theatre Seating: 600 Approx

Banquet Seating: 500 Approx

Tradeshow Booths: 83 Approx (10 x 10)

Entrances: Double Doors (2), Single Door with ramp (1)

Lighting: Fluorescent – on/off switch

Audio/Visual:

XLR inputs (2, shared with Exhibition Hall, West-center pillar)

¼ inch inputs (2, shared with Exhibition Hall, West-center pillar)

Fixed house speakers (Linkable with all lower level rooms)

**Agricultural Specs:**

Stalling: 84 (10 ft x 10 ft)

**Features:**

Loading Overhead Door: 14 ft x 11 ft (South to Hitching Ring)

Washrooms: Located in Exhibition Hall

Dividing Curtain: Opens into Exhibition Hall



# EXHIBITION HALL

# CITY SQUARE

MENS & WOMENS

OH 14'w x 10'h

OH 10'w x 10'h

OH 12'w x 10'h

RAMP

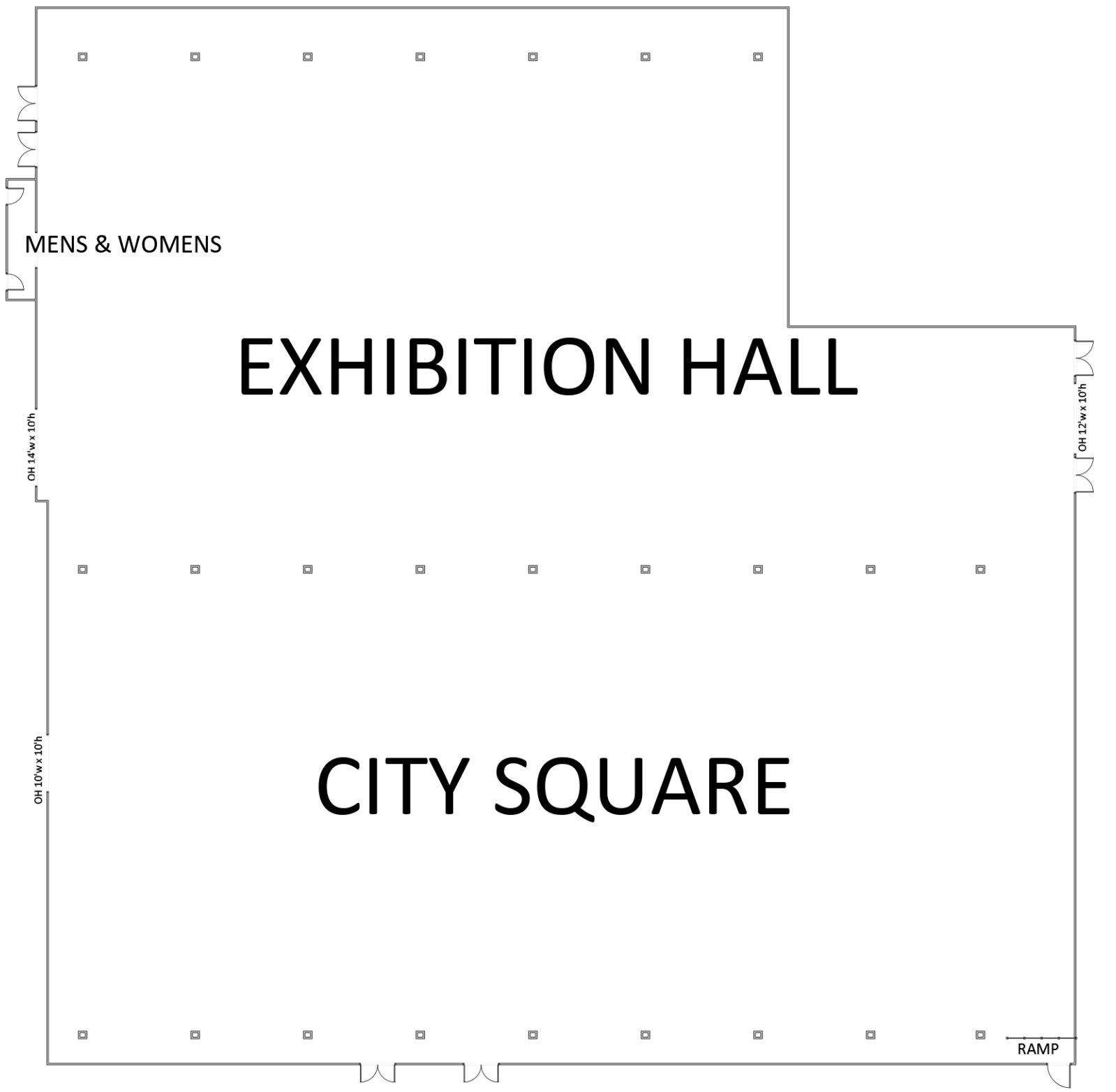

# Salon A

**Room Details:**

Dimensions: 35 ft x 59 ft (2,065 ft<sup>2</sup>)

Location: Lower Level

Ceiling: 12 ft

Flooring: Tile

**Convention:**

Theatre Seating: 150 Approx

Banquet Seating: 120 Approx

Entrances: Double Doors (3), Single Door (1)

Lighting: Fluorescent – on/off switch

Audio/Visual:

XLR inputs (2)

VGA input

Fixed house speakers (Linkable with all lower level rooms)

**Features:**

Bar/Canteen Room: 9 ft 10 ft with overhead roll-up window

Double Door: Connects to Salon B

# Salon B

**Room Details:**

Dimensions: 29 ft x 29 ft (841 ft<sup>2</sup>)

Location: Lower Level

Ceiling: 12 ft

Flooring: Tile

**Convention:**

Theatre Seating: 60 Approx

Banquet Seating: 40 Approx

Entrances: Double Doors (2), Single Door (1)

Lighting: Fluorescent – on/off switch

**Features:**

Double Door: Connects to Salon A



# Upper Curling Club Lounge

## **Room Details:**

Dimensions: 29 ft x 85 ft (2,465 ft<sup>2</sup>)

Location: Lower Level

Ceiling: 8 ft 5 in

Flooring: Laminate

## **Convention:**

Theatre Seating: 180 Approx

Banquet Seating: 150 Approx

Entrances: Single Doors (2)

Lighting: Fluorescent – on/off switches

Audio/Visual:

XLR input (1) (East Wall)

Fixed house Speakers (Linkable with Lower Curling Club and Ice Level)

8 Small TV's for broadcasting

## **Features:**

Washrooms: Men's & Women's

Bar: Full Service, located on the West side of the lounge

Viewing Area: North Wall, oversee Ice Level

Elevator: Access Lower Curling Club Lounge

# Lower Curling Club Lounge

## Room Details:

Dimensions: 29 ft x 68 ft (1,972 ft<sup>2</sup>)

Location: Lower Level

Ceiling: 8 ft 5 in (Lowest), 9 ft 6 in (Highest)

Flooring: Laminate

Entrances: Double Door (1, Accessible)

Lighting: Fluorescent – on/off switches

Audio/Visual:

XLR input (1) (Northeast Wall)

Fixed house speakers (Linkable with Upper Curling Club Lounge and Ice Level)

8 Small TV's for broadcasting

## Features:

Washrooms: Men's & Women's

Canteen: Concessions and beverage products

Glass Wall: North Wall oversees Ice Level

Elevator: Accesses Upper Curling Club Lounge



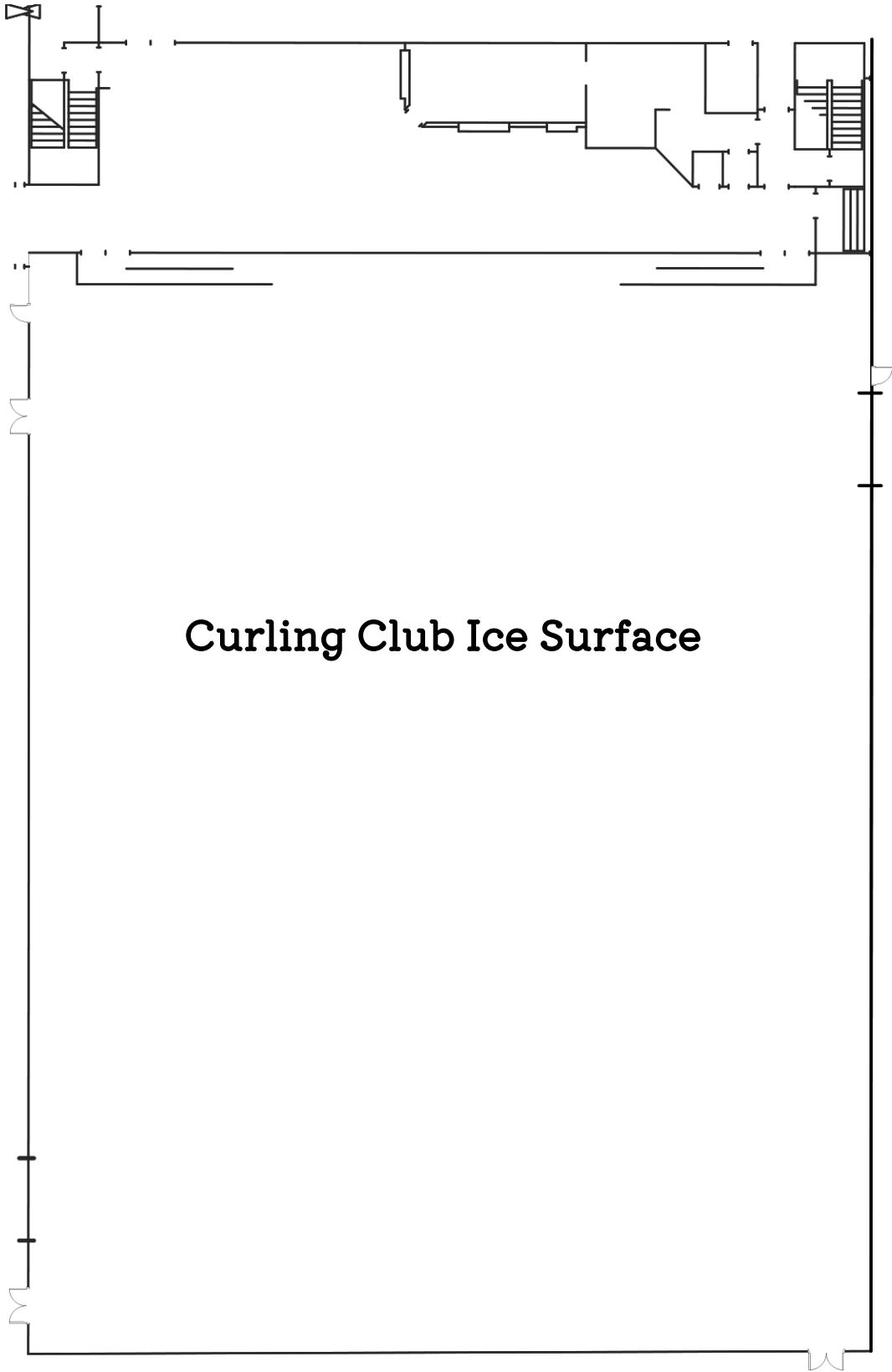

**Curling Club Ice Surface**

# Hitching Ring

## **Room Details:**

Dimensions: 119 ft x 69 ft (8,211 ft<sup>2</sup>)

Location: Lower Level (Backstage area to Assiniboine Credit Union Place)

Ceiling: 15 ft 2 in (Highest), 13 ft 2 in (Lowest)

Flooring: Concrete

Entrances: Double Doors (2, Interior), Ramps (2, Interior to City Square & Exhibition Hall)

Lighting: Fluorescent-row switches

## **Features:**

Loading Overhead Door: 14 ft x 12 ft (West, Exterior)

14 ft x 12 ft (Southeast, to Assiniboine Credit Union Place Ice Level)

14 ft x 12 ft (Southwest, to Assiniboine Credit Union Place Ice Level)

Power: Limitations vary contact Director of Operations for details

# HITCHING RING



# Assiniboine Credit Union Place

- Guest Services Team:** Assiniboine Credit Union Place provides complete guest services staffing for all events. These team members include ushers, ticket takers, box office staff, security personnel, house-keeping, and public first aid.
- Box Office:** Assiniboine Credit Union Place Box Office is located on the main lobby. The Box Office is open at 11:00 AM on all event days. The Box Office hours are dependent on the special event schedule. The Box Office regular hours are 11:00 AM – 5:00 PM, Wednesday – Friday.
- Merchandise:** The Keystone Centre provides the operations and sale of event merchandise at the arena. A written agreement between the Keystone Centre and lessee will be executed for the sharing of merchandising revenue. Please contact Director of Events for details.
- Seating Capacity:**
- 4,600 Fixed seats
  - 7 Private Suites (Occupancy: 20 per suite)
  - Suite availability is dependent on sightline.
  - Hockey – 4,600
  - Rodeo – 3,780
  - Full Bowl Concert – 4,948
  - Half Bowl Concert – 3,406
  - Theatre – 1,477
  - Standing Room – 300

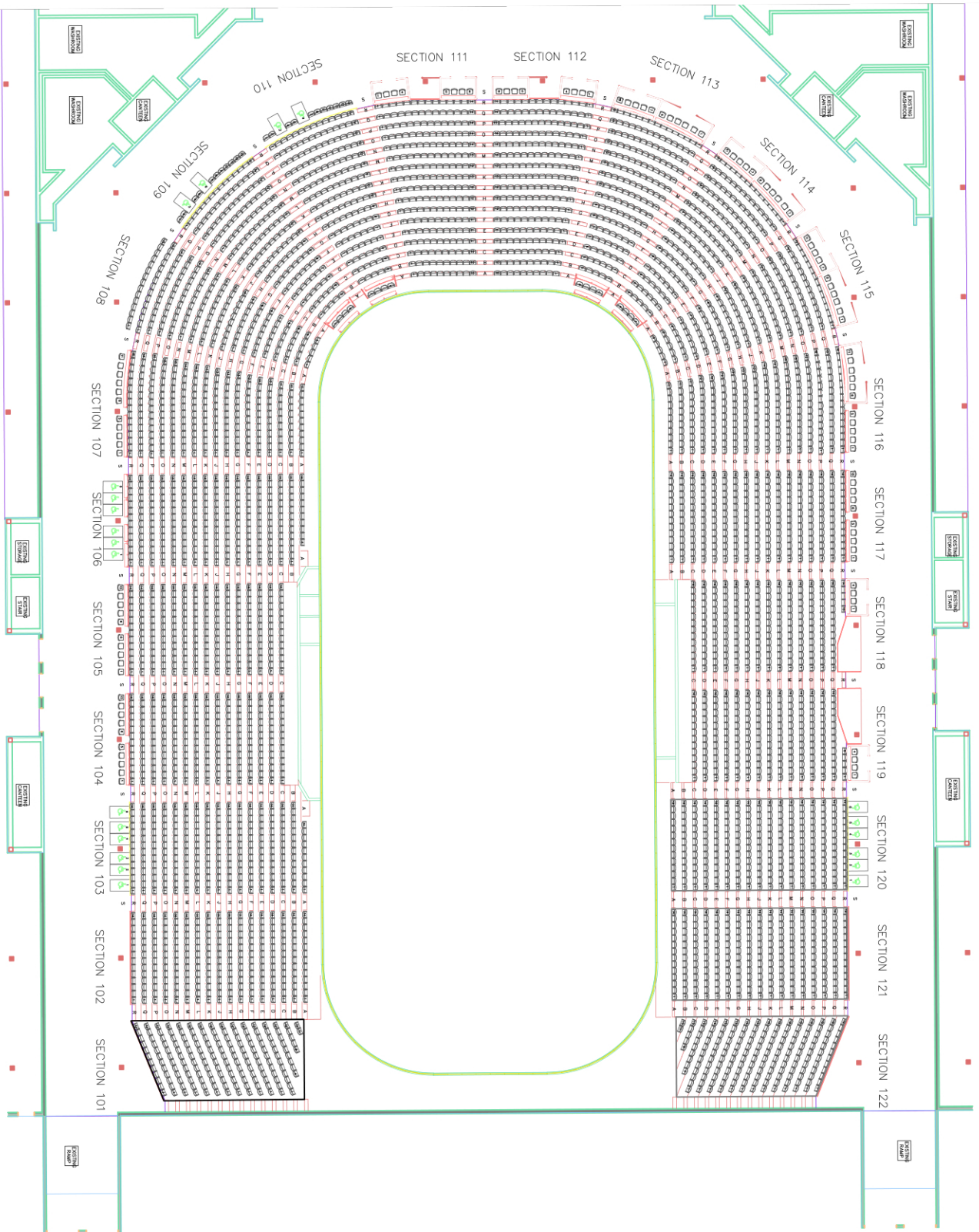

# Enns Brothers Arena

## **Room Details:**

Dimensions: 120 ft x 210 ft (25,200 ft<sup>2</sup>)

Location: Lower Level

Ceiling: 25 ft

Flooring: Concrete

Entrances: Double Doors (2)

## **Arena Specs:**

Ice Rink: 85 ft x 200 ft

Seating Capacity: 650, retractable bleachers

Accessible Seating: Elevated platform with ramp

Dressing Rooms: 1 Referee Change Room

1 Universal Change Room

4 Full size Change Rooms with washroom and showers

## **Features:**

Loading Overhead Doors: 16 ft x 16 ft (North)

16 ft x 12 ft (Northeast)

14 ft x 12 ft (Southeast)

Canteen/Eating Area: Full service Canteen with seating between the rinks

Hockey Essentials: "Between the Rinks" skate sharpening and supplies

Washrooms: Located on Mainstreet Hallways

# Flynn Arena

## **Room Details:**

Dimensions: 120 ft x 210 ft (25,200 ft<sup>2</sup>)

Location: Lower Level

Ceiling: 25 ft

Flooring: Concrete

Entrances: Double Doors (2)

## **Arena Specs:**

Ice Rink: 85 ft x 200 ft

Seat Capacity: 650, retractable bleachers

Accessible Seating: Elevated platform with ramp

Dressing Rooms: 1 Referee Change Room

1 Universal Change Room

4 Full size Change Rooms with washroom and showers

## **Features:**

Loading Overhead Doors: 16 ft x 16 ft (North)

16 ft x 12 ft (Northwest)

14 ft x 12 ft (Southwest)

Canteen/Eating Areas: Full service Canteen with seating between the rinks

Hockey Essentials: "Between the Rinks" skate sharpening and supplies

Washrooms: Located on Mainstreet Hallways



# Assiniboine Credit Union Agricultural Centre

The northern-most features of the Keystone Centre, and the facility's premium agricultural amenities are located within the Assiniboine Credit Union Agricultural Centre.

The Assiniboine Credit Union Agricultural Centre is comprised of an indoor and outdoor show ring, 5 barns connected to the main facility, a concessionaire, and bathroom facilities.

**Rooms Included:**

Canada Room  
Assiniboine Credit Union Indoor Show Ring  
Assiniboine Credit Union Outdoor Show Ring  
Barns 1, 2, 3, 4 & 11

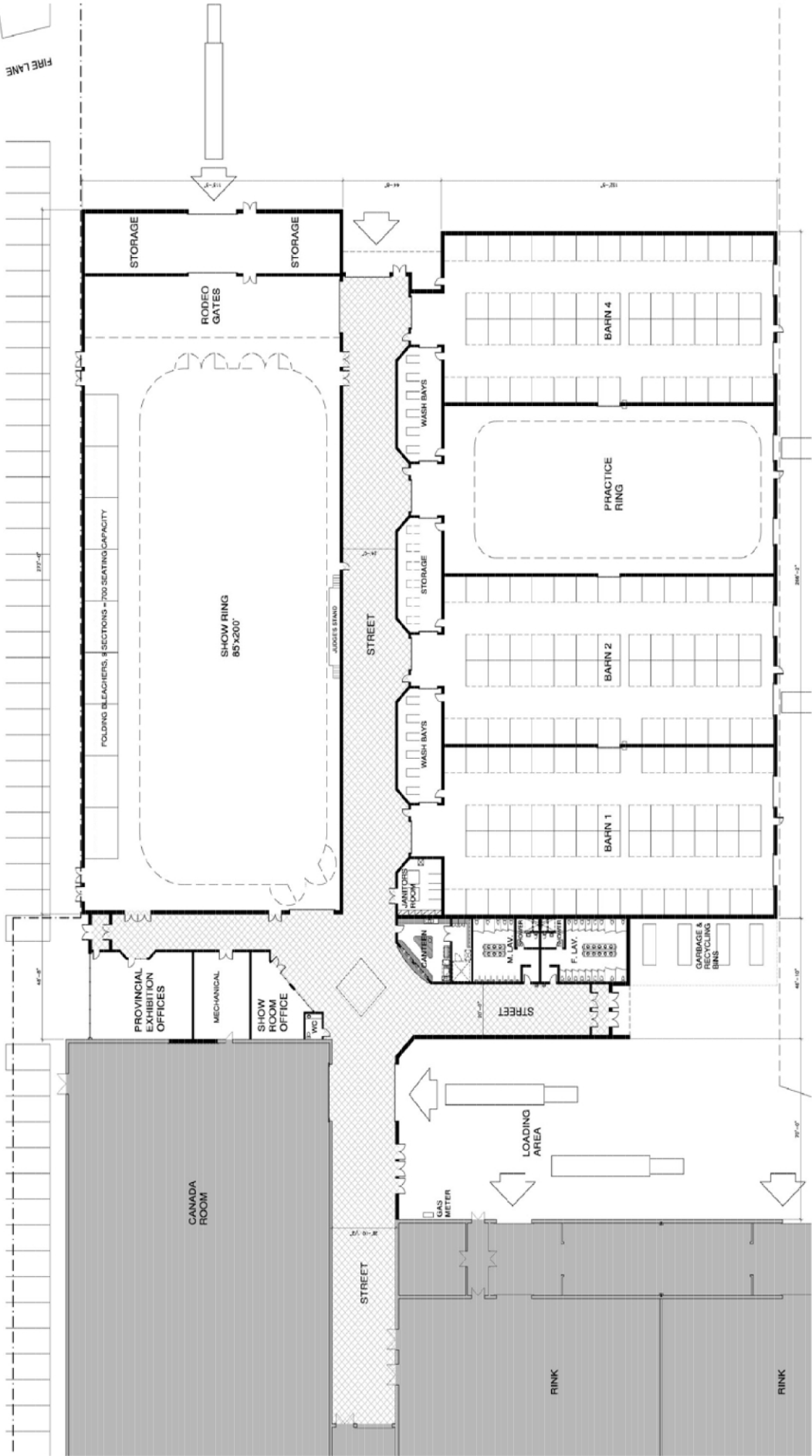

**SCHEMATIC PLAN**  
 SCALE: 1/8" = 1'-0"

**KEYSTONE CENTRE  
 STABLES & SHOW RING**  
EDMONTON

**MCM  
 ARCHITECTS  
 INC.**

DESIGNED BY: DCL  
 ARCHITECTED BY: MUF  
 DRAWN BY: MCM/MLP/2004

# Canada Room

## **Room Details:**

Dimensions: 118 ft x 177 ft (20,886 ft<sup>2</sup>)  
Location: Assiniboine Credit Union Agricultural Centre  
Ceiling: 17 ft 6 in  
Flooring: Concrete

## **Convention:**

Theatre Seating: 800 Approx  
Banquet Seating: 800 Approx  
Tradeshow Booths: 115 Approx (10 ft x 10 ft)  
Entrances: Double Doors (5)  
Lighting: Fluorescent-row switches  
Audio/Visual:  
XLR inputs (3)  
Fixed house speakers (Linkable with all lower level rooms)

## **Agricultural Specs:**

Max Stalls: 116 (10 ft x 10 ft box stalls)  
Wash Rack: 28 ft x 95 ft – 15 wash bays

## **Features:**

Loading Overhead Doors: 22 ft x 17 ft 5 in (North)  
12 ft x 12 ft (South)  
Office Space: 10 ft x 10 ft (South Wall, Glass Window)  
Storage Room: 10 ft x 11 ft with overhead roll-up window



# Assiniboine Credit Union Indoor Show Ring

**Room Details:**

Ring Size: 91 ft x 200 ft  
Ceiling: 21 ft  
Location: Assiniboine Credit Union Agricultural Centre  
Footings: Clay and Sand Mixture  
Capacity: 700, bleacher seating

**Convention:**

112 ft x 240 ft (26,880 ft<sup>2</sup>)

**Features:**

Loading Overhead Doors: 22 ft x 18 ft (North)  
16 ft 5 in x 14 ft (Ag Foyer)  
16 ft 5 in x 14 ft (Hallway)  
Announcer Stand: Located on the West side of the Assiniboine Credit Union Show Ring, audio connection, independent show ring announcer microphone and dedicated barn page microphone are provided.  
Power: Limitations vary. Contact Ag Manager for details.

# Assiniboine Credit Union Outdoor Show Ring

<b><u>Ring Size:</u></b>	255 ft x 300 ft
<b><u>Footing:</u></b>	2 in of sand on top of packed shale
<b><u>Announcer Stand:</u></b>	Enclosed announcer stand with paging capabilities to all barns and hallways
<b><u>Capacity:</u></b>	700, bleacher seating (additional bleachers can be brought in as requested)

# Assiniboine Credit Union Barn 1, 2, 3, 4, and 11

## **Barn 1 Details:**

Dimensions: 63 ft x 150 ft (9,450 ft<sup>2</sup>)  
Ceiling: 17 ft 6 in  
Loading Overhead Door: 13 ft x 10 ft (East)  
12 ft x 12 ft (Hallway)  
Fixed Stalls: 29 (10 ft x 10 ft)  
Centre Stalls: 24 (10 ft x 10 ft)  
Max Stalls: 53  
Wash Racks: 6 Stalls (Shared with Barn 2)  
Power: Limitations vary. Contact Ag Manager for details.

## **Barn 2 Details:**

Dimensions: 63 ft x 150 ft (9,450 ft<sup>2</sup>)  
Ceiling: 17 ft 6 in  
Loading Overhead Door: 13 ft x 10 ft (East)  
12 ft x 12 ft (Hallway)  
Fixed Stalls: 28 (10 ft x 10 ft)  
Centre Stalls: 24 (10 ft x 10 ft)  
Max Stalls: 52  
Wash Racks: 6 Stalls (Shared with Barn 1)  
Power: Limitations vary. Contact Ag Manager for details.

## **Barn 3 Details:**

Dimensions: 64 ft x 150 ft (9,600 ft<sup>2</sup>)  
Ceiling: 17 ft 6 in  
Loading Overhead Door: 13 ft x 12 ft (East)  
12 ft x 12 ft (Hallway)  
Footing: Clay and sand mixture  
Centre Hi Quall: 29 (10 ft x 10 ft)  
Wash Racks: 6 Stalls (Shared with Barn 4)  
Power: Limitations vary. Contact Ag Manager for details.

## **Barn 4 Details:**

Dimensions: 68 ft x 150 ft (10,200 ft<sup>2</sup>)  
Ceiling: 17 ft 6 in  
Loading Overhead Door: 13 ft x 12 ft (East)  
12 ft x 12 ft (Hallway)  
Fixed Stalls: 29 (10 ft x 10 ft)  
Centre Stalls: 24 (10 ft x 10 ft)  
Max Stalls: 53  
Wash Racks: 6 Stalls (Shared with Barn 3)  
Power: Limitations vary. Contact Ag Manager for details.

## **Barn 11 Details:**

Dimensions: 58 ft x 101 ft (5,858 ft<sup>2</sup>)  
Ceiling: 12 ft  
Loading Overhead Door: 13 ft x 10 ft (East)  
8 ft x 8 ft (West to Flynn Arena)  
Flooring: Concrete  
Max Stalls: 34 (10 ft x 10 ft)  
Power: Limitations vary. Contact Ag Manager for details.

# Upper, and Lower Level Hallways

**Main Lobby (East-West):** Dimensions: 249 ft x 29 ft (widest), 21 ft (narrowest) (6,474 ft<sup>2</sup>)  
Ceiling: 8 ft (Lowest), 10 ft (Highest)  
Flooring: Tile  
Lighting: Fluorescent  
Tradeshow Booths: 14 (10 x 8)

**Blue Hallway (North-South):** Dimensions: 273 ft x 19 ft (5,187 ft<sup>2</sup>) (Up to Canteen)  
Ceiling: 10 ft (Lowest), 11 ft (Highest)  
Flooring: Concrete  
Lighting: Fluorescent  
Tradeshow Booths: 14 (10 x 8)

**Purple Hallway (East-West):** Dimensions: 344 ft x 19 ft (6,536 ft<sup>2</sup>)  
Ceiling: 12 ft (Lowest), 13 ft (Highest)  
Flooring: Concrete  
Lighting: Fluorescent  
Tradeshow Booths: 18 (10 x 8)

# South Parking Lot, and South Grassed Lot

**South Parking Lot Details:** Dimensions: 290 ft x 440 ft (127,440 ft<sup>2</sup>)  
Location: South of Assiniboine Credit Union Place  
Access: Queens Ave, Richmond Ave, 13<sup>th</sup> Street, Canad West Parking Lot  
Parking: Keystone Lot, Grassed Lot

**Features:** Power: 200 AMP Staff Parking, 100 AMP North \*additional power can be run, charges apply  
Water: Non-potable (available upon request)

**South Grassed Lot Details:** Dimensions: 578 ft x 879 ft (508,062 ft<sup>2</sup>)  
Location: South Grounds  
Access: Queens Ave, Richmond Ave, 13<sup>th</sup> Street  
Parking: Keystone Lot, Grassed Area

**Features:** Power: 200 AMP US \*additional power can be run, charges apply  
Water: Non-potable (available upon request)

## Grounds, and Parking Lot Specs

**Lot Sizes:**

- Lot 1: 190 ft x 328 ft
- Lot 2: 85 ft x 461 ft
- Lot 3: 246 ft x 200 ft
- Lot 4: 379 ft x 290 ft
- Lot 5: 545 ft x 191 ft
- Lot 6: 290 ft x 440 ft
- Lot 7: 305 ft x 162 ft
- South Grass: 580 ft x 445 ft
- South Grass #2: 520 ft x 400 ft
- East Grass: 710 ft x 415 ft

# ELECTRICAL LEGEND

- 200AMP – 1 PHASE
- 200AMP – 3 PHASE
- 100AMP – 1 PHASE
- 60AMP – 1 PHASE
- 50AMP – 1 PHASE
- 400AMP – 3 PHASE

# KEYSTONE CENTRE GROUNDS ELECTRICAL

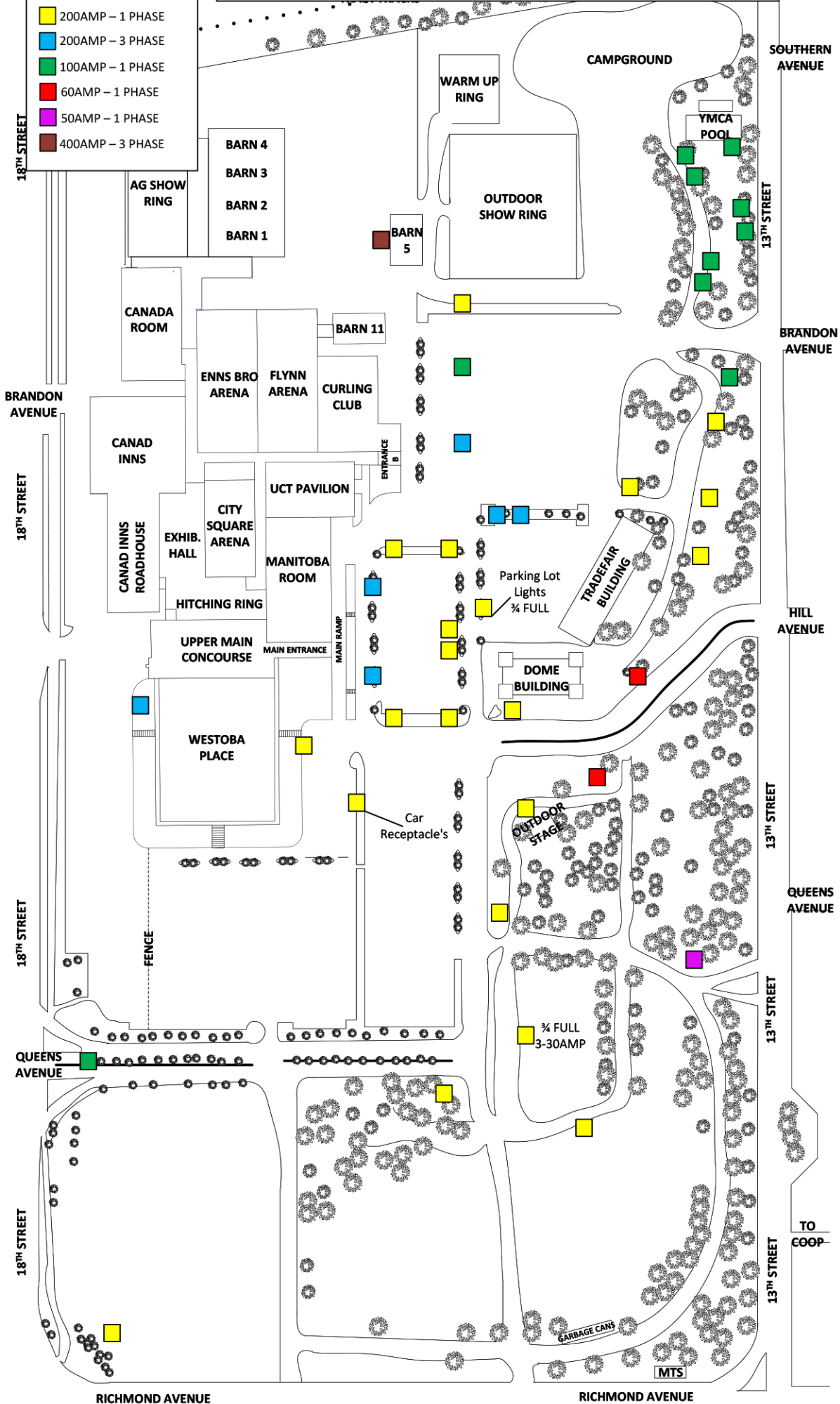

RICHMOND AVENUE

RICHMOND AVENUE

TO COOP

# Convention, and Tradeshow

<b><u>Chairs:</u></b>	Red Padded: 400, Burgundy Padded: 475 Black Plastic: 1600
<b><u>Tables:</u></b>	Plastic 8 ft: 125, Wood 8 ft: 215 Plastic Rounds 5 ft: 65 Wood Rounds 5 ft: 83, Wood Rounds 4 ft: 28 Plastic 4 ft: 6, Wood 4 ft: 16 Cocktail Tables: 10
<b><u>Linen:</u></b>	White and Black Tablecloths Assorted colored napkins
<b><u>Pipe &amp; Drape:</u></b>	Black 16 ft x 10 ft Sections: 8 Burgundy 8 ft x 10 ft Sections: 15
<b><u>Audio/Visual:</u></b>	Podiums: 10 Wired Microphones: 4 Wireless Microphones: 8 Mixers: 1 Portable XLR Speakers: 2 Pairs Portable Projector: 1 Portable Projector Screens: 1 (5 ft) Assorted Cables: HDMI, VGA, Mini display, Aux, XLR
<b><u>Electrical:</u></b>	Assorted extension cords and power bars A-frame Power Drops: 15amp receptacle
<b><u>Stage:</u></b>	Stage Deck: 8 x 4 x 2 – 6ft: 81 stage Stage Deck Frames: Adjustable 4ft – 6ft: 15 frames Stage Deck Frames: 1,5 ft – 2 ft: 7 frames Blue Carpet: 8 x 4 – 18 in high: 51 stage
<b><u>Catering:</u></b>	In-house: Sodexo Live!
<b><u>Internet &amp; Phones:</u></b>	The Keystone Centre had WIFI internet throughout the building, a password will be provided to you during your event from the Sales Manager. If hard-wired internet and phone lines are required these must have a 7 day advance notice in order to avoid late fees. Please contact Sales Manager for details.

Additional or alternative amenities from the list above can be discussed with the Sales Department and their trusted partners.

# Agricultural

**Ag Equipment:**

2 – John Deer 5115M Tractors  
1 – 8 ft Kiser arena drag  
1 – 10ft Kiser arena drag  
2 – In-house forklifts  
1 – In-house 40 ft Scissor lift

**Footing:**

Sand and clay mixture. See Ag Manager for additional details.

**Power Drops:**

Power drops are available. Please contact Ag Manager for details.

**Tradeshow Booths:**

Centre hallways.

Max capacity 65 – 10 ft x 10 ft booths in Assiniboine Credit Union Ag

**Ring Workings:**

The Keystone Centre is a unionized building. All equipment will only be operated by authorized Keystone Centre employees.

**Internet & Phones:**

The Keystone Centre has WIFI internet throughout the building, a password will be provided to your event from the Ag Manager. If hard-wired internet and phone lines are required these must have a 7 day notice in order to avoid late fees. Please contact Ag Manager for details.

# Assiniboine Credit Union Agricultural Centre Sound

## **House Sound System:**

The house sound system is able to provide a multitude of arrangements with barn paging and independent sound in each barn/ring. This extends to our Outdoor Show Ring as well. The system is made up of custom, full range speakers and horns strategically placed around the arena and barns. Independent sound can be provided as required. Please contact Ag Manager for details.

## Stalling, and Steel

### **Hi Quall Stalls:**

10ft x 10ft w/ sliding door. Located in Barn 1, 2, 3,4 and Canada Room

### **Stalls:**

67 – 10 ft x 10 ft with swinging door – Located in the center rows in Barns 1, 2, 3, 5. Ability to be set up in other event locations as required.

### **Heavy Horse Stalls:**

5 ft x 10 ft – Check with Ag Manager for availability

### **Cattle Steel:**

83 – 10 ft x 10 ft  
92 – 8 ft x 10 ft

### **Blue Steel:**

159 – 10 ft panels

### **Range Panels:**

7 – 29 ft

# Camping

## Serviced Sites:

The Keystone Centre has 40 30 amp full-service on-site camping spots, 4 50AMP full-service camping spots, as well as 40 no-service sites. These sites are available to book through our website at [www.keystonecentre.com](http://www.keystonecentre.com)

## Overflow Camping:

Additional camp spots are available upon request. \*Additional charges apply for service

