



2024-2025 TECHNICAL PACKAGE

Where Westman Comes Together



1 204 726 3555 | www.keystonecentre.com | 1-1175 18th St, Brandon Manitoba

CONTENTS

GENERAL INFORMATION

Address, and Contact Information	Page 3
Facility Layout Maps	Page 4
Loading In, Parking, and Directions	Page 5
Loading Door & Parking Lot Maps	Page 6

UPPER LEVEL ROOMS

Assembly Hall	Page 7
WCG Viewing Lounge	Page 8
Pioneer Lounge	Page 9
MNP Hall	Page 10
Amphitheatre	Page 12
Upper Level Hallways	Page 13

LOWER LEVEL ROOMS

Manitoba Room	Page 14
UCT Pavilion	Page 15
City Square	Page 16
Exhibition Hall	Page 17
Salon A	Page 18
Salon B	Page 19
Lower Level Hallways	Page 20
Upper Curling Club Lounge	Page 21
Lower Curling Club Lounge	Page 22
Curling Club Ice Surface	Page 23
Hitching Ring	Page 24

MAIN ARENA

Westoba Place	Page 25
---------------	---------

COMMUNITY ICE RINKS

Enns Brother Arena	Page 26
Flynn Arena	Page 27

WESTOBA CREDIT UNION AGRICULTURAL CENTRE OF EXCELLENCE

Canada Room	Page 28
Westoba Credit Union Show Ring	Page 29
Outdoor Show Ring	Page 30
Barn 1	Page 31
Barn 2	Page 32
Barn 3	Page 33
Barn 4	Page 34
Barn 11	Page 35

OUTDOOR GROUNDS

Outdoor Stage Area / East Grassed Lot	Page 36
South Parking Lot	Page 37
South Grassed Lot	Page 38
Grounds & Parking Lot Specs	Page 39
Outdoor Electrical	Page 40

SERVICES AND AMENITIES

Convention/Tradeshow	Page 41
Agricultural	Page 42
Camping	Page 44

ADDRESS, BUILDING, & CONTACT INFORMATION

Mailing and Physical Address

Keystone Centre
#1-1175 18th street
Brandon, MB
R7A 7C5
204.726.3500 MAIN
204.727.5552 FAX

The original Keystone Centre opened its doors in 1972, the product of a joint venture between the City of Brandon, the Government of Manitoba, the Provincial Exhibition of Manitoba (the Fair) and private donors. The Keystone Agricultural and Recreation Centre Inc. is a freestanding non-profit corporation that owns and operates the 90 acres of property and all of the buildings known as the Keystone Centre. Today the Keystone Centre sits in Brandon's busiest commercial district, offers 540,000 square feet of multi-use rooms under one roof and boasts over 1,500 event days annually. With a capacity of 5,000 for concerts, 6,000 for meetings, 5,400 for sporting events, and 2,800 for banquets, the Keystone Centre is truly a versatile and multi-functional venue, capable of hosting world class events.

Contacting the Keystone Centre

CEO & General Manager

Connie Lawrence
204.729.3752
connie@keystonecentre.com

Sales Manager

Julie Shiloff
204.726.3502
julie@keystonecentre.com

Ice bookings

Eric Rutherford 2
04.726.3553
eric@keystonecentre.com

Director of Events

Adam Cudal
204.726.3523
adam@keystonecentre.com

Director of Operations

Steven Gabriel
204.726.3505
steven@keystonecentre.com

Ag. Centre Sales Manager

Devin Epp
204.726.3556
dave@keystonecentre.com

Director of Ticketing

Jared McKenzie
204.726.3534
jared@keystonecentre.com

For General Info: 204.726.3500

Online Information: www.keystonecentre.com

FACILITY MAPS

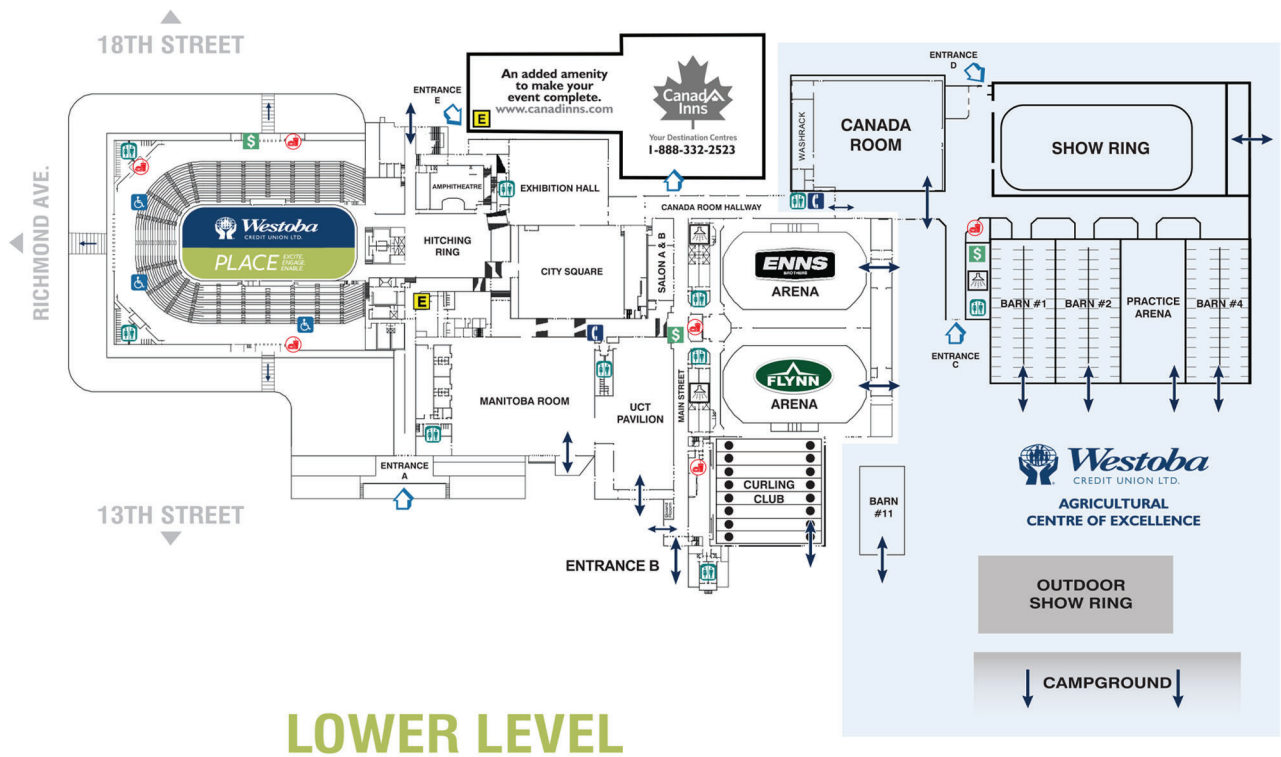

LOADING IN, PARKING, & DIRECTIONS

Loading Door(s): Multiple loading doors based on the location of your event. Contact Sales or Event Manager for loading door use. (Refer to Maps on pg. 6)

Parking and Delivery Access: Access to the loading door and parking needs to be arranged with the Sales Manager

Directions:

FROM WINNIPEG, MB: (Approx. 2hr drive time)

Head West to Trans-Canada Hwy/MB-1W, turn left onto MB-110 S, turn right onto Richmond Ave E, turn right onto Manitoba 10N (18th Street), and the Keystone Centre will be on your right.

FROM REGINA, SK: (Approx. 3.5hr drive time)

Head East to Trans-Canada Hwy/SK -1 E, to Trans-Canada/MB-1AE, turn right onto 18th Street / MB 10N, and the Keystone Centre will be on your left.

FROM MINNEAPOLIS, MN: (Approx. 9hr drive time)

Follow 1-94 W, take exit 349B to merge onto I-29N/US-81 N towards Grand Forks, continue straight on MB-75N, keep left to continue on Lord Selkirk Hwy/MB-75N, turn left onto Boyne Ave W/MB-23W, turn right onto Provincial Trunk Hwy 34N (signs for Manitoba 34/ Holland), turn left onto MB-2 W (signs for Souris), turn right onto MB-10N/MB-2W (signs for Brandon), and the Keystone Centre will be on your right.

FROM MINOT, ND: (Approx. 3hr drive time)

Head North on US-83N, turn right onto ND-5 E / US-83 N, continue straight on ND-5 E, turn left onto ND-14N, continue on Provincial Trunk Hwy 21N, turn right onto MB-23E (signs for Elgin), turn left onto MB-10N (signs for Brandon), and the Keystone Centre will be on your right.

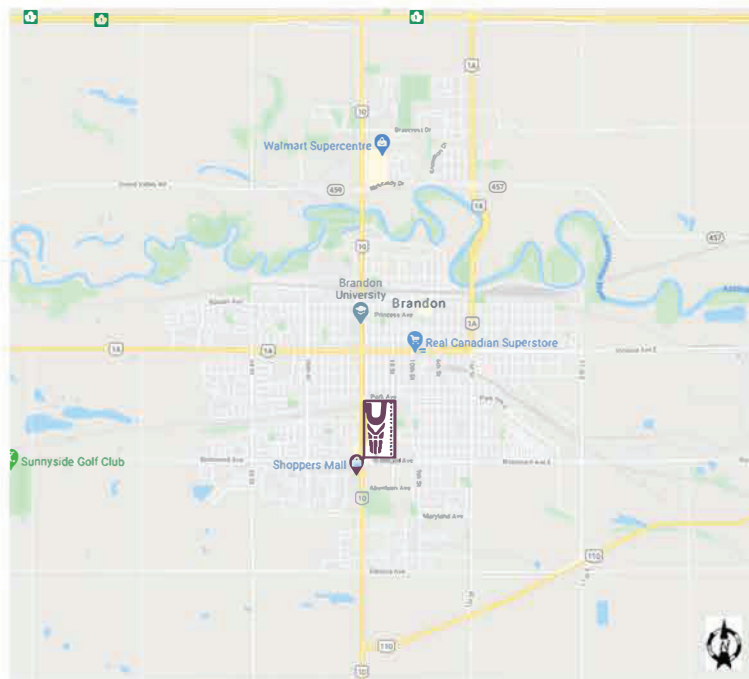

LOADING DOOR MAP

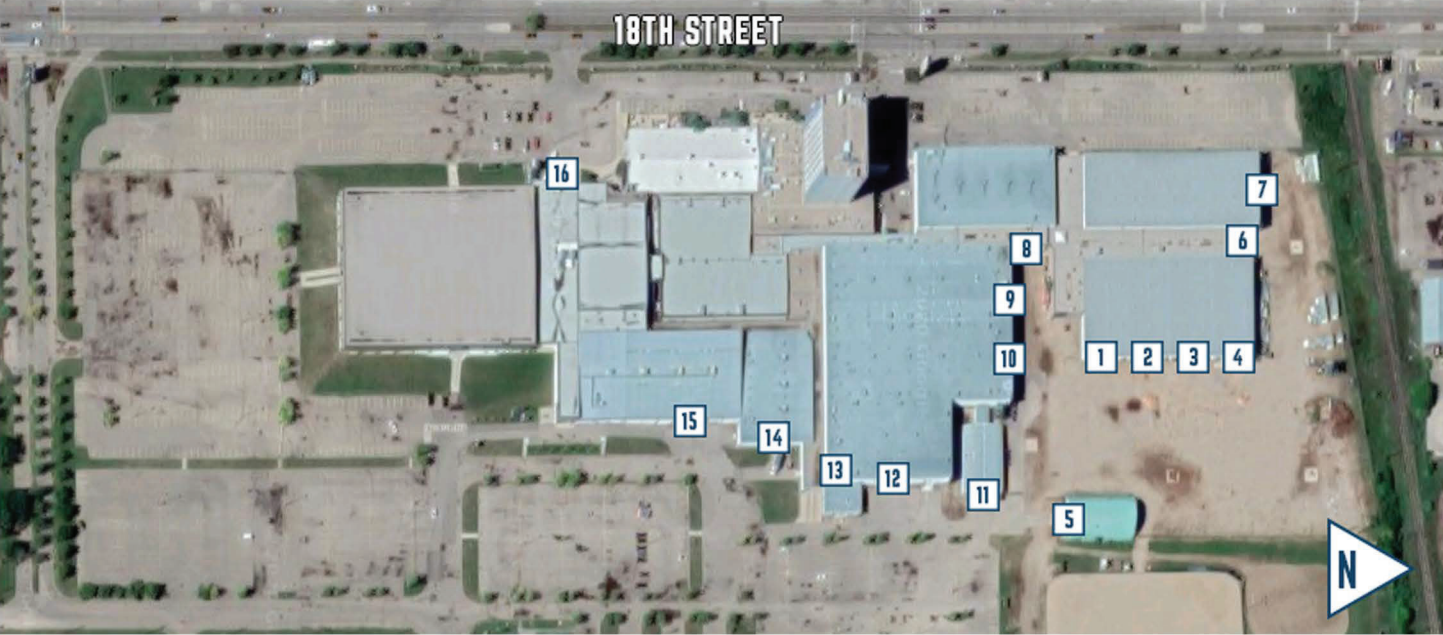

PARKING LOT MAP

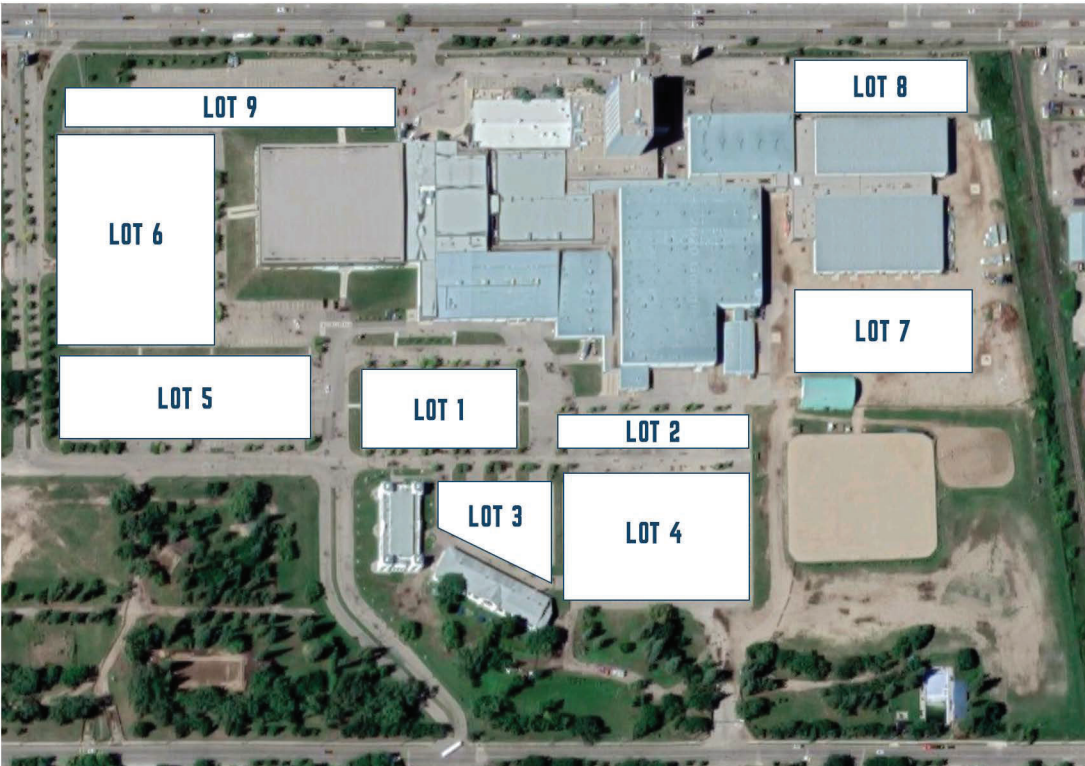

ASSEMBLY HALL

Room Details: **Dimensions:** 39ft x 44ft (1,716ft²)
Location: Upper level
Ceiling: 9ft 10in
Flooring: Carpet

Convention: **Theatre Seating:** 140 approx
Banquet Seating: 90 approx
Entrances: Double doors (2)
Lighting: Fluorescent-on/off switches, dimmable pot light switches
Audio/Visual:
Fixed ceiling hung projector
HDMI & VGA input (1 ea.) (West wall)
Fixed pull-down screen (West wall)
XLR inputs (2) (West & South wall)
Fixed house speakers (linkable with WCG Viewing Lounge)

Features: **Fireplace:** Gas-adjustable
Washrooms: Men's and Women's
Bar Window: Shared bar with WCG Viewing Lounge
Room Divider: Opens into the WCG Viewing Lounge
Window: Overlooks Westoba Place (South wall)

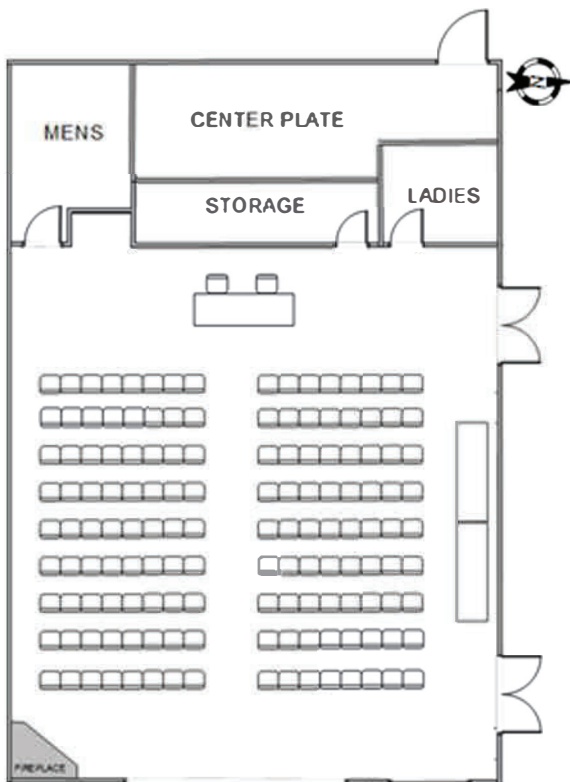

WCG VIEWING LOUNGE

Room Details: **Dimensions:** 30ft x 44ft (1,320ft²)
Location: Upper level
Ceiling: 9ft 10in
Flooring: Carpet

Convention: **Theatre Seating:** 110 approx
Banquet Seating: 48 approx
Entrances: Double doors (1)
Lighting: Fluorescent-on/off switches, dimmable pot light switches
Audio/Visual:
 Fixed TV (East wall)
 XLR inputs (1) (West wall)
 Fixed house speakers (linkable with Assembly Hall)

Features: **Washrooms:** Men's and Women's
Bar Window: Shared bar with Assembly Hall
Room Divider: Opens into the Assembly Hall
Coat Rack: Fixed (inside main entrance)
Lower Viewing Level: 10 bar stools & 5 cocktail tables
Window: Overlooks Westoba Place (South wall)

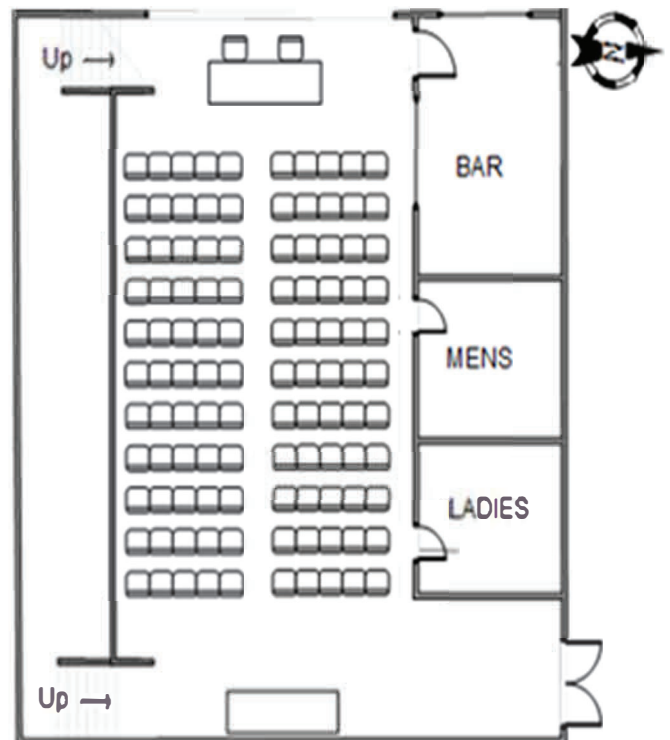

PIONEER LOUNGE

Room Details:

Dimensions: 30ft x 50ft (1,500ft²)

Location: Upper level

Ceiling: 8ft 10in

Flooring: Carpet

Convention:

Theatre Seating: 180 approx

Banquet Seating: 88 approx

Entrances: Double doors (2)

Lighting: Fluorescent - on/off switch

Audio/Visual:

Fixed ceiling hung projector

HDMI & VGA input (East wall)

Fixed pull-down screen (East wall)

XLR inputs (2)

Fixed house speakers

Features:

Washrooms: Men's and Women's

Window: Overlooks Manitoba Room (North wall)

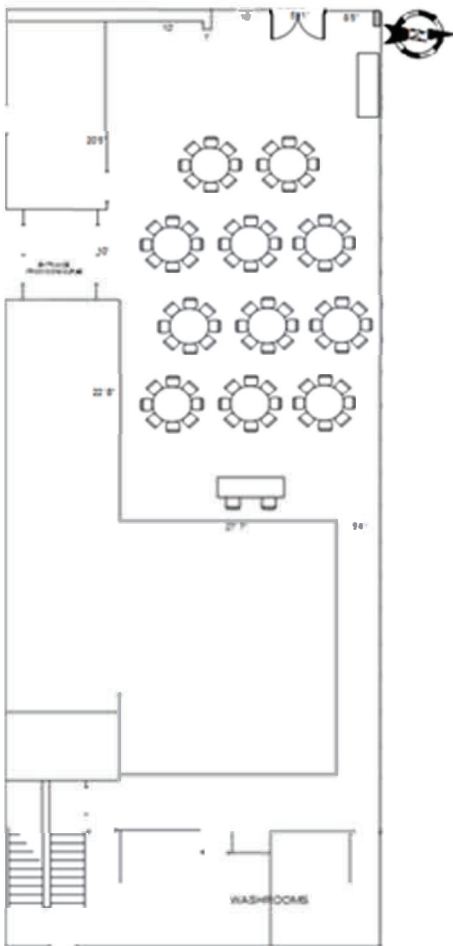

MNP HALL (FULL ROOM)

Room Details:

Dimensions: 91ft x 86ft (7,826 ft²)

Location: Upper level

Ceiling: 13ft 6in

Flooring: Laminate

Convention:

Theatre Seating: 520 approx

Banquet Seating: 350 approx

Entrances: Double doors (2), single doors (2)

Lighting: Fluorescent-row switches, dimmable pot light switches

Audio/Visual:

Fixed ceiling hung projectors (2) (NW & NE corner, linkable via NW input)

Fixed pull-down screens (2) (Northwest and Northeast corner)

HDMI & AUX input (2) (West and North wall)

XLR input (6) (East, West, and North wall)

Fixed house speakers (able to separate between the 2 sides)

Features:

Room Divider: Splits the room in half (MNP A: West & MNP B: East)

Sectioned wall divider allow pass through (7ft 11in/panel)

Washrooms: Men's and Women's (located outside MNP Hall on Lobby)

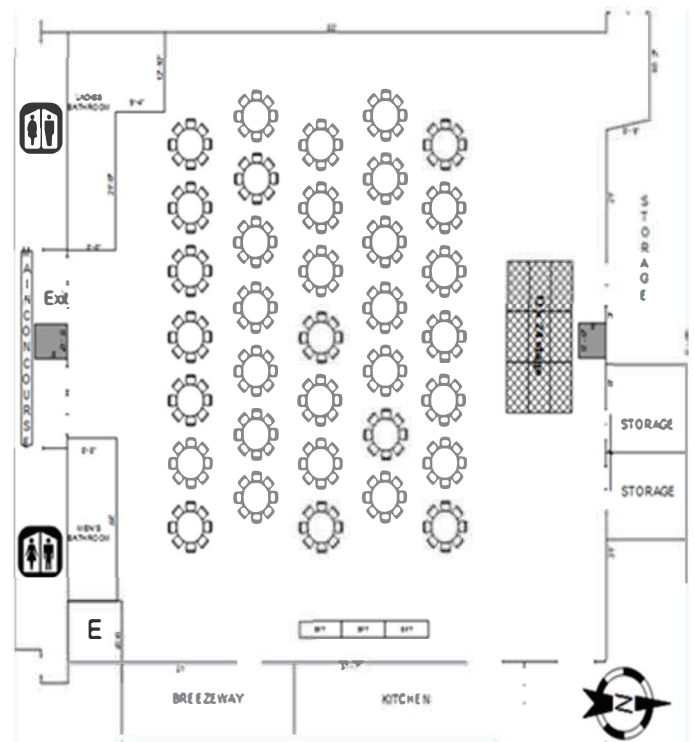

MNP HALL A & B (HALF ROOM)

Room Details:

Dimensions: 45ft x 86ft (3,870 ft²)

Location: Upper level

Ceiling: 13ft 6in

Flooring: Laminate

Convention:

Theatre Seating: 260 approx

Banquet Seating: 160 approx

Entrances: Double doors (1), single doors (1)

Lighting: Fluorescent-row switches, dimmable pot light switches

Audio/Visual:

Fixed ceiling hung projectors (1) (A: Northwest and B: Northeast corner)

Fixed pull-down screens (1) (A: Northwest and B: Northeast corner)

HDMI & AUX input (2) (A: West and B: North wall)

XLR input (6) (A: West & North, B: East & North wall)

Fixed house speakers

Features:

Room Divider: Splits the room in half (MNP A: West & MNP B: East)

Sectioned wall divider allow pass through (7ft 11in/panel)

Washrooms: Men's and Women's (located outside MNP Hall on Main Lobby)

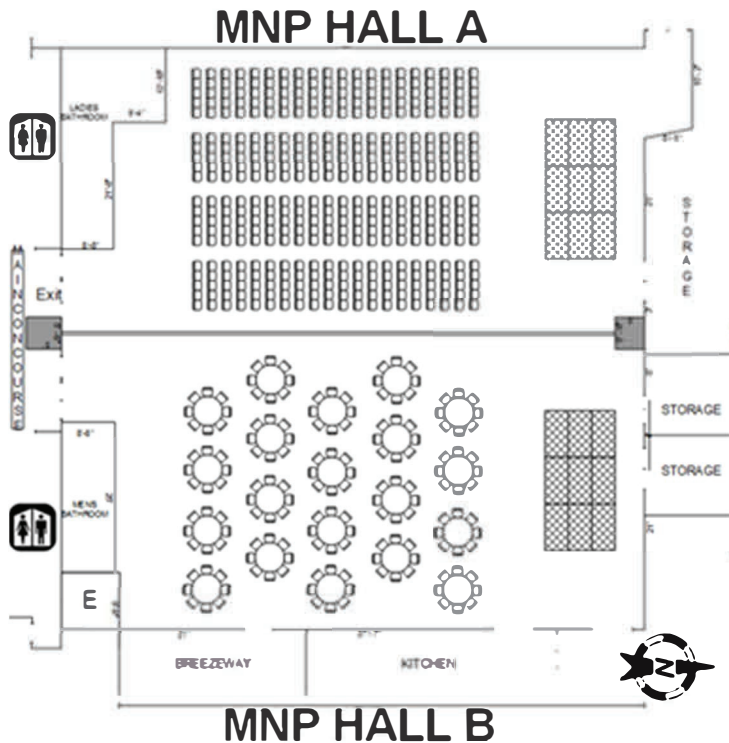

AMPHITHEATRE

Room Details:

Dimensions: 65ft x 100ft (6,500 ft²)

Location: Upper level

Ceiling: 11ft (upper level), 24ft 7in (stage level)

Flooring: Carpet

Fixed seating: 571 (including 25 wheelchair accessible seating)

Entrances: Double doors (3)

Lighting: Fluorescent-row switches

Audio/Visual:

Fixed ceiling hung projector (West wall)

VGA & AUX input (East wall on ground level)

Fixed screen (East wall)

XLR inputs (5) (East wall on ground level)

Fixed house speakers

Features:

Semi-circle center stage: 28ft x 25ft ground level

Loading overhead door: 21ft 11in x 10ft

Stage right and left exits: Stage right exit via ramp. Stage left exit via stairs

Washrooms: Men's and Women's (located outside Amphitheatre on Main Lobby)

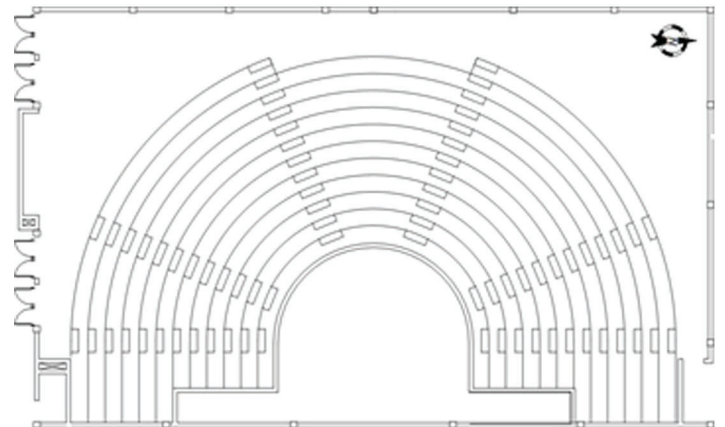

UPPER LEVEL HALLWAY

Main Lobby (East-West):

Dimensions: 249ft x 29ft (widest), 21ft (narrowest) (6,474 ft²)

Ceiling: 8ft (low), 10ft (high)

Flooring: Tile

Lighting: Fluorescent

Tradeshow Booths: 14 (10ft x 8ft)

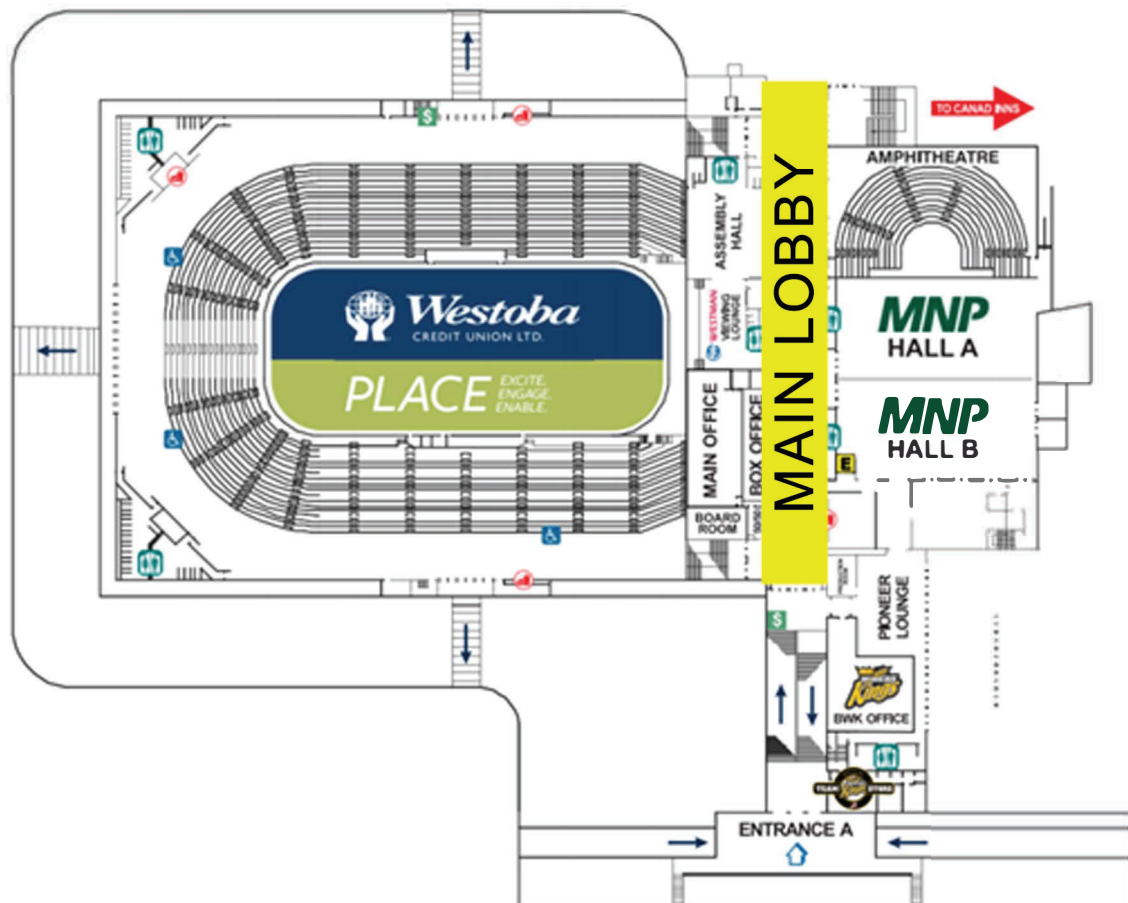
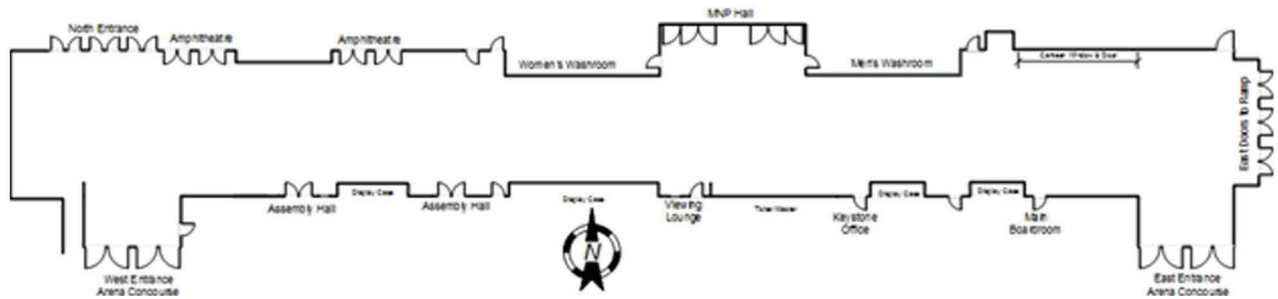

MANITOBA ROOM

Room Details: **Dimensions:** 130ft x 200ft (26,000 ft²)
Location: Lower level
Ceiling: 17ft 2in (low/West), 22ft 11in (middle), 27ft (high/East)
Flooring: Concrete

Convention: **Theatre Seating:** 2500 approx
Banquet Seating: 1024 approx
Concert Seating: 1700 approx
Tradeshow Booths: 131 approx (10ft x 10ft)
Entrances: Double doors (4, interior), single doors (10, exterior)
Lighting: LED-row switches
Audio/Visual:
 XLR inputs (6)
 Fixed housespeakers (linkable with all lower level rooms)

Agricultural Specs: **Stalling:** 123 – 10ft x 10ft

Features: **Loading Overhead Door:** 22ft x 15ft 6in (East)
Connecting Overhead Door: 12ft x 12ft (opens into UCT Pavilion)
Office Space: 10ft x 11ft (South wall, glass windows)
Washrooms: Men's and Women's (2 sets)
 (South set of washrooms shared with UCT Pavilion)

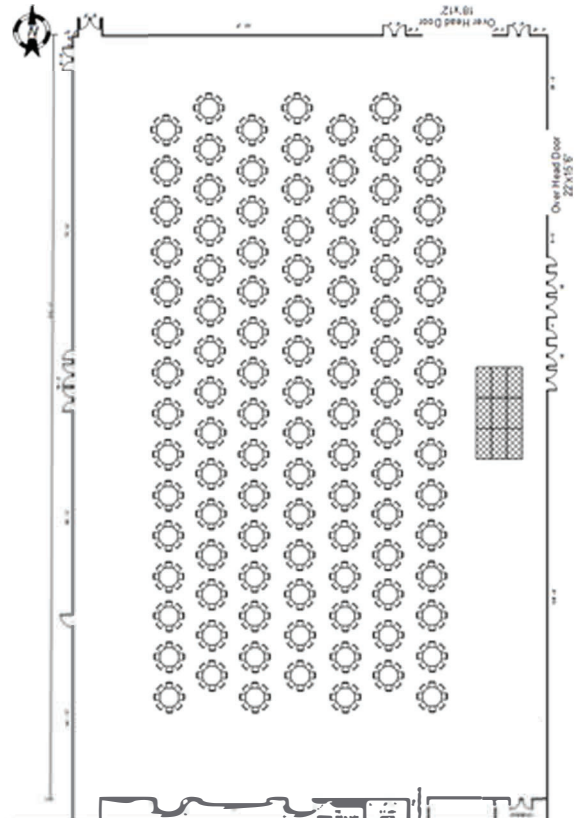

UCT PAVILION

Room Details: **Dimensions:** 85ft x 170ft (14,450 ft²)
Location: Lower level
Ceiling: 12ft 9in (low), 13ft 9in (high)
Flooring: Tile

Convention: **Theatre Seating:** 1120 approx
Banquet Seating: 600 approx
Tradeshow Booths: 56 approx (10ft x 10ft)
Entrances: Double doors (7)
Lighting: LED-row switches, independent stage lights (North centre)
Audio/Visual:
 XLR inputs (4)
 Fixed house speakers (linkable with all lower level rooms)

Features: **Loading Overhead Door:** 10ft x 10ft (East)
Connecting Overhead Door: Opens into Manitoba Room
Washrooms: Men's and Women's (shared with Manitoba Room)
Alcove Area: Separate light switches

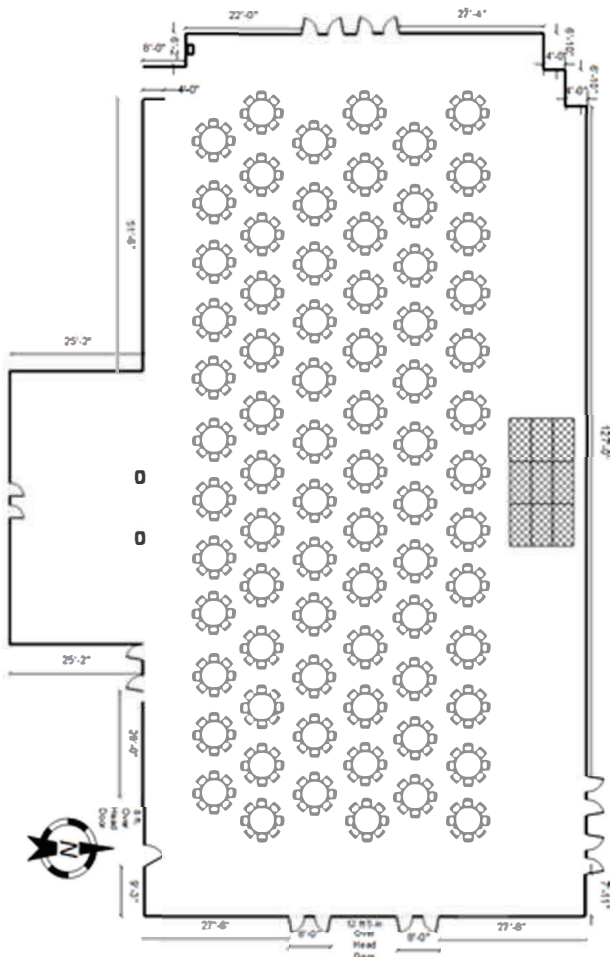

CITY SQUARE

Room Details: **Dimensions:** 190ft x 84ft (15,960 ft²)
Location: Lower level
Ceiling: 14ft 4in
Flooring: Concrete

Convention: **Theatre Seating:** 600 approx
Banquet Seating: 500 approx
Tradeshow Booths: 83 approx (10ft x 10ft)
Entrances: Double doors (2), single door w/ ramp (1)
Lighting: Fluorescent - on/off switch
Audio/Visual:
 XLR inputs (2, shared with Exhibition Hall, West-center pillar)
 1/4 inch inputs (2, shared with Exhibition Hall, West-center pillars)
 Fixed house speakers (linkable with all lower level rooms)

Agricultural Specs: **Stalling:** 84 - 10ft x 10ft

Features: **Loading Overhead Door:** 14ft x 11ft (South to Hitching Ring)
Washrooms: Located in Exhibition Hall
Dividing Curtain: Opens into Exhibition Hall

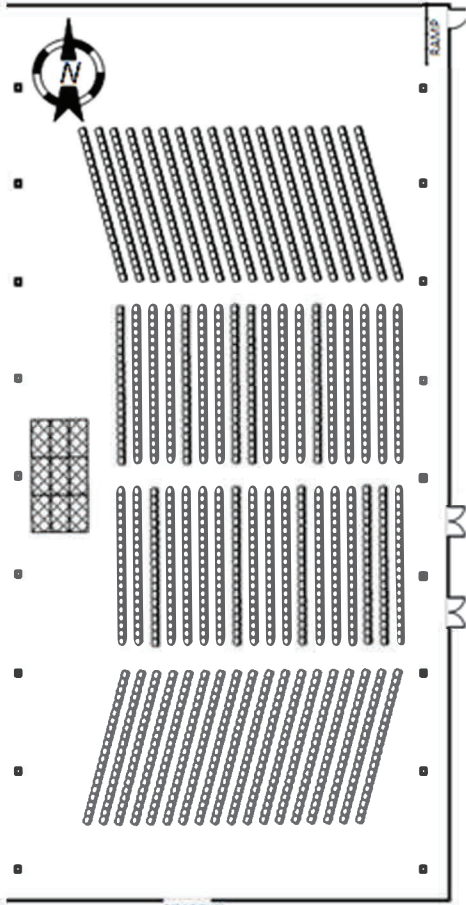

EXHIBITION HALL

Room Details: **Dimensions:** 93ft x 140ft (13,020 ft²)
Location: Lower level
Ceiling: 14ft 4in
Flooring: Concrete

Convention: **Theatre Seating:** 500 approx
Banquet Seating: 400 approx
Tradeshow Booths: 62 approx (10ft x 10ft)
Entrances: Double doors (2)
Lighting: Fluorescent - on/off switch
Audio/Visual:
 XLR inputs (2, shared with Exhibition Hall, West-center pillar)
 1/4 inch input (shared with Exhibition Hall, West-center pillars)
 Fixed house speakers (linkable with all lower level rooms)

Agricultural Specs: **Stalling:** 75 - 10ft x 10ft

Features: **Loading Overhead Door:** 11ft x 10ft (North to Ag Centre), 15ft x 11ft (South to Hitching Ring)
Washrooms: Men's and Women's
Dividing Sliding Curtain: Opens into City Square

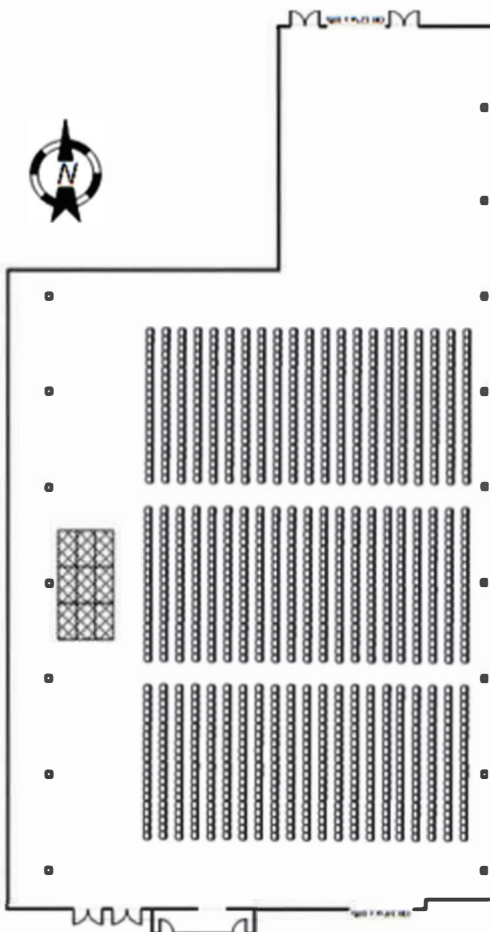

SALON A

Room Details:

Dimensions: 36ft x 60ft (2,160 ft²)

Location: Lower level

Ceiling: 12ft

Flooring: Tile

Convention:

Theatre Seating: 240 approx

Banquet Seating: 120 approx

Entrances: Double doors (3), single door (1)

Lighting: Fluorescent - on/off switch

Audio/Visual:

XLR inputs (2)

VGA input

Fixed house speakers (linkable with all lower level rooms)

Features:

Bar/Canteen Room: 9ft x 10ft w/ overhead roll-up window

Double Door: Connects to Salon B

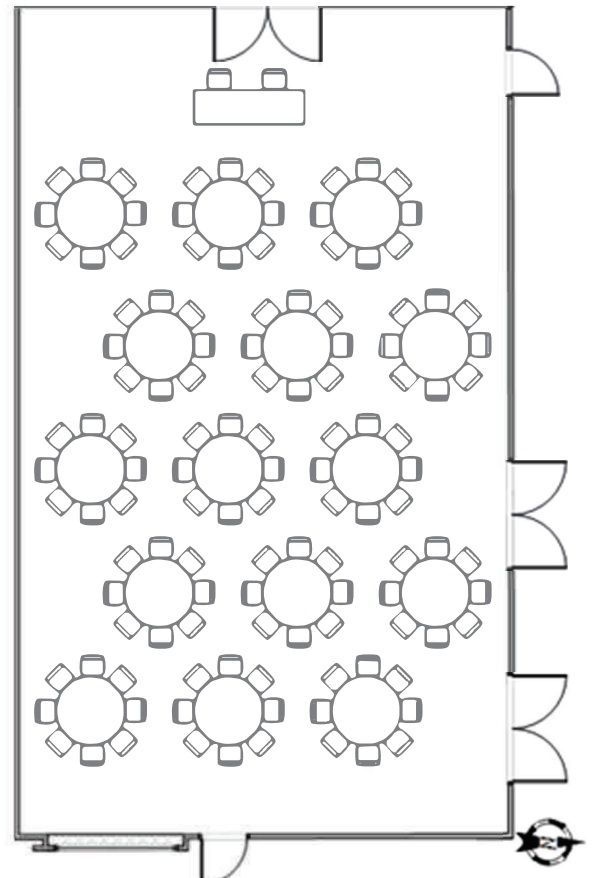

SALON B

Room Details:

Dimensions: 30ft x 30ft (900 ft²)

Location: Lower Level

Ceiling: 12ft

Flooring: Tile

Convention:

Theatre Seating: 80 approx

Banquet Seating: 40 approx

Entrances: Double doors (2), single door (1)

Lighting: Fluorescent - on/off switch

Audio/Visual:

XLR inputs (1)

Fixed house speakers (linkable with all lower level rooms)

Features:

Double Door: Connects to Salon A

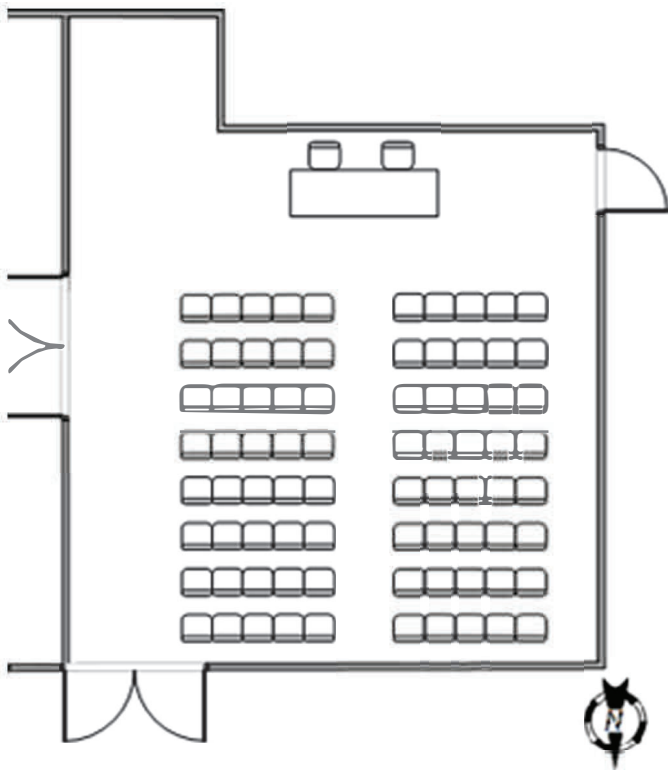

LOWER LEVEL HALLWAYS

Blue Hallway (North-South)

Dimensions: 273ft x 19ft (5,187 ft²)

Ceiling: 10ft (low), 11ft (high)

Flooring: Concrete

Lighting: Fluorescent

Tradeshow Booths: 14 (10ft x 8ft)

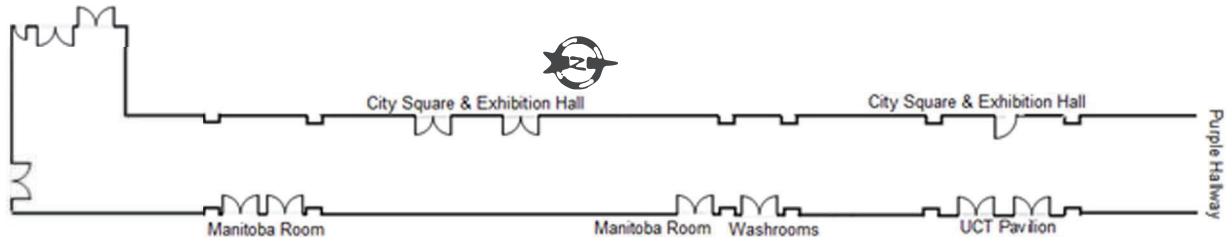

Purple Hallway (East-West):

Dimensions: 344ft x 19ft (6,536 ft²)

Ceiling: 12ft (low), 13ft (high)

Flooring: Concrete

Lighting: Fluorescent

Tradeshow Booths: 18 (10ft x 8ft)

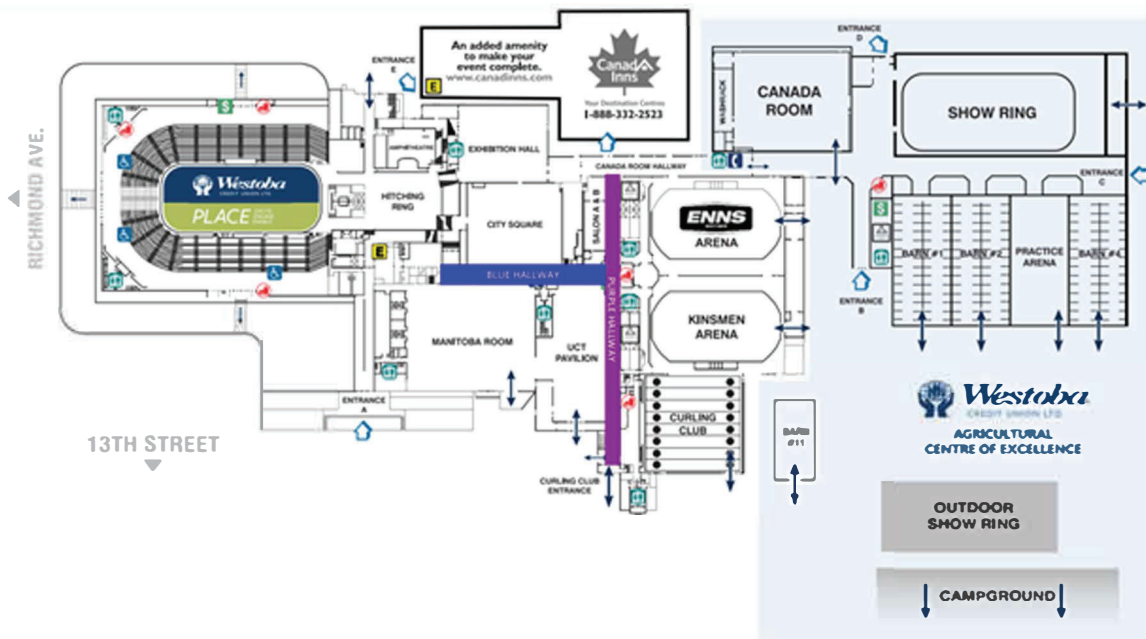
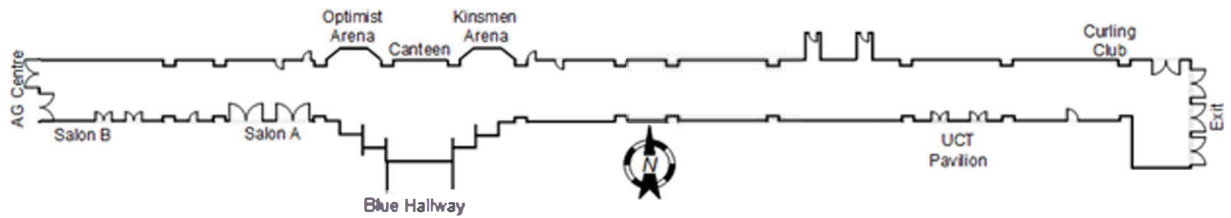

UPPER CURLING CLUB LOUNGE

Room Details:

Dimensions: 30ft x 88ft (2,460ft²)

Location: Lower Level

Ceiling: 8ft 6in

Flooring: Laminate and carpet

Convention:

Banquet Seating: 150 approx

Theatre Seating: 180 approx

Entrances: Single doors (2)

Lighting: Fluorescent-on/off switches

Audio/Visual:

XLR input (1) (East wall)

Fixed house speakers (linkable with Lower Curling Club and ice level)

Large (2) & Small (8) TV's for broadcasting

Features:

Washrooms: Men's and Women's

Bar: Full Service, located on the west side of lounge

Viewing Area: North wall, oversees ice level

Elevator: Accesses Lower Curling Club Lounge

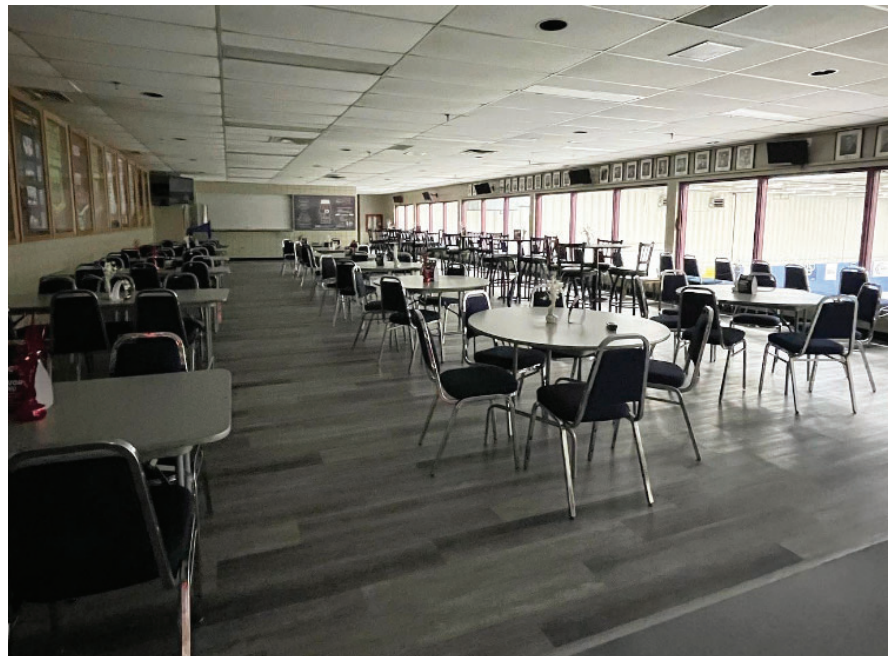
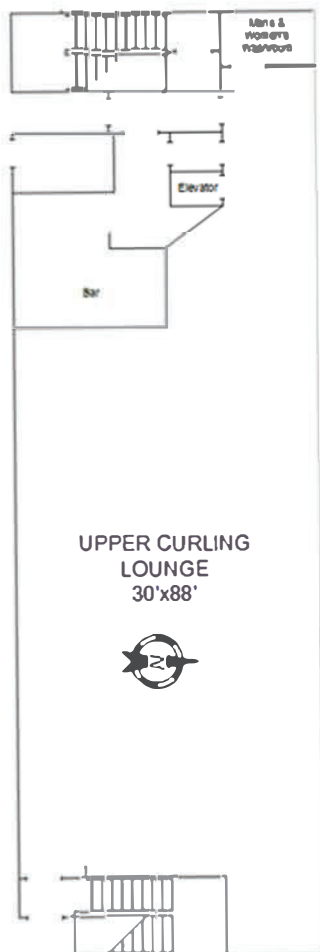

LOWER CURLING CLUB LOUNGE

Room Details:

- Dimensions:** 30ft x 60ft (1,800ft²)
- Location:** Lower Level
- Ceiling:** 8ft 5in (low), 9ft 6in (high)
- Flooring:** Laminate
- Entrances:** Double doors (1, accessible)
- Lighting:** Fluorescent - on/off switches
- Audio/Visual:**
 - XLR input (1) (Northeast wall)
 - Fixed house speakers (linkable with Upper Curling Club Lounge and ice level)
 - Small TV's for broadcasting (9)

Features:

- Washrooms:** Men's and Women's
- Canteen:** Concessions and beverage products
- Glass Wall:** North wall, oversees ice level
- Elevator:** Accesses Upper Curling Club Lounge

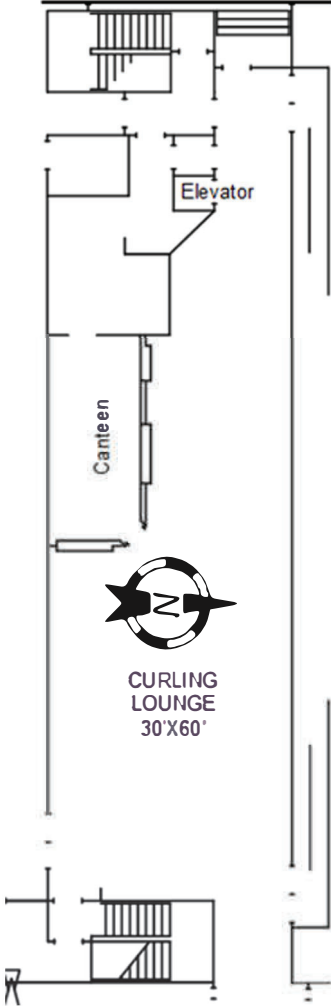

CURLING CLUB ICE SURFACE

The Brandon Curling is a tenant of the Keystone Centre. For rental of this space during the curling season (October to March) please contact the Brandon Curling Club - 204.726.3560 or brandoncurls@wcgwave.ca

Room Details: **Dimensions:** 120ft x 160ft (19,200ft²)
Location: Lower Level
Ceiling: 22ft 5in
Flooring: Concrete
Entrances: Single doors (2 with ramps. accessible), Double doors (3, fire exits)
Lighting: Fluorescent - on/off switches

Curling Ice: 8 full size ice sheets

Convention: **Audio/Visual:**
Fixed house speakers (linkable with Main and Upper Lounge)

Agricultural: **Booths:** 92
Stalling: 92 – 10ft x 10ft *additional conversion charges apply*

Features: **Loading Overhead Door:** 15ft 9in x 16' (East)
13ft 8in x 12' (West, to Flynn Arena)

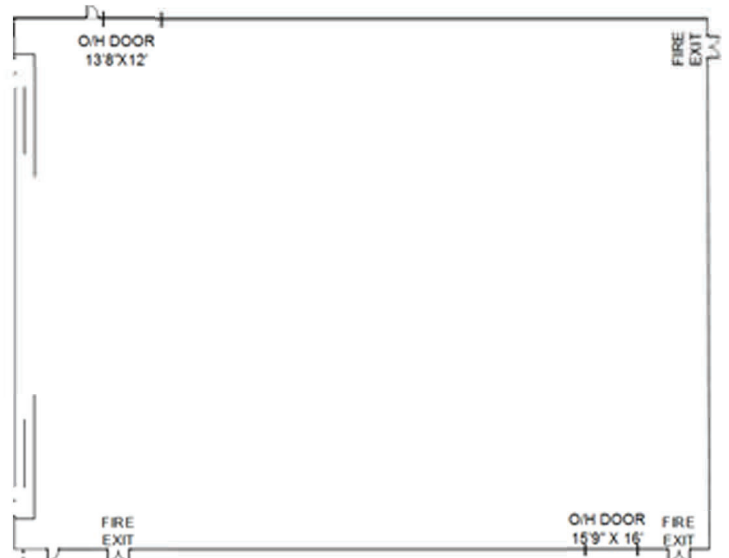

HITCHING RING

Room Details:

Dimensions: 120ft x 70ft (8,400 ft²)

Location: Lower Level (Backstage area to Westoba Place)

Ceiling: 15ft 2in (high), 13ft 2in (low)

Flooring: Concrete

Entrances: Double doors (2, interior), ramps (2, interior, to City Square & Exhibition Hall)

Lighting: Fluorescent-row switches

Features:

Loading Overhead Door: 13ft x 14ft (West, exterior)

13ft x 10ft (Southeast, to Main Arena Ice Level)

14ft x 12ft (Southwest, to Main Arena Ice Level)

Power: Limitations vary contact Director of Operations for details.

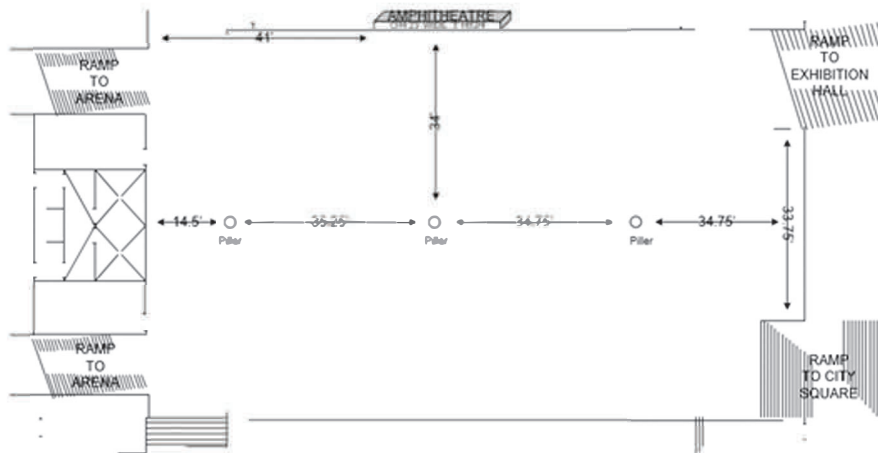

WESTOBA PLACE

Guest Services Team: Westoba Place provides complete guest services staffing for all events. These team members include, ushers, ticket takers, box office staff, security personnel, house-keeping, and public first aid.

Box Office: Westoba Place Box Office is located on the main lobby. The Box Office is open at 11am on all event days. The Box Office hours are dependent on the special event schedule. The Box Office regular hours are 11am - 5pm, Wednesday - Friday. The Box Office accepts all credit cards, cash, and debit, and operates on Ticketmaster.

Merchandise: The Keystone Centre provides the operations and sale of event merchandise at the arena. A written agreement between Keystone Centre and lessee will be executed for the sharing of merchandising revenue. Please contact Director of Events for details.

Seating Capacity: 5,102 fixed seats
7 private suites (occupancy: 20 per suite). Suite availability is dependent on sightlines.

Hockey	5,531
Figure Skating	5,327
Rodeo	5,542
Full Bowl Concert	5,915
Half Bowl Concert	3,250
ffl Bowl Concert	4,633
Theatre	2,493
Standing Room	300

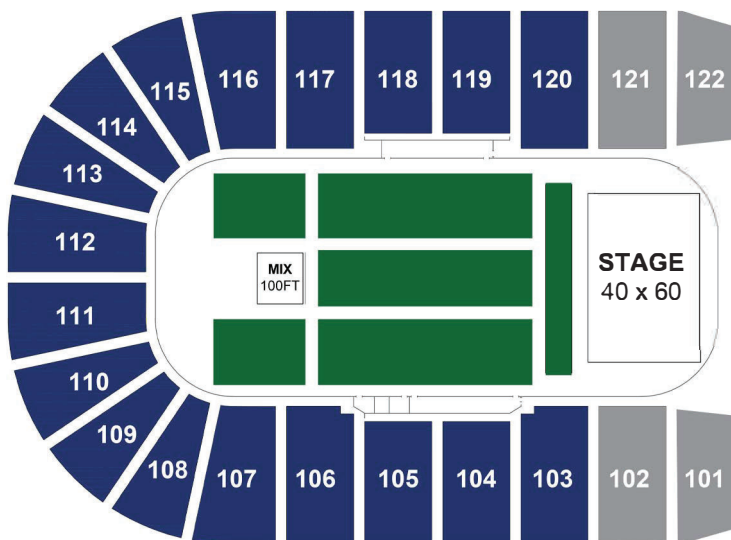

ENNS BROTHERS ARENA

Room Details: **Dimensions:** 120ft x 210ft (25,200 ft²)
Location: Lower level
Ceiling: 25ft
Flooring: Concrete
Entrances: Double doors (2)

Arena Specs: **Ice Rink:** 85ft x 200ft
Seating Capacity: 500, retractable bleachers
Accessible Seating: Elevated platform with ramp
Dressing Rooms: 1 Referee Change Room
 1 Universal Change Room
 4 Full size Change Rooms with washroom and showers

Features: **Loading Overhead Door:** 13ft 8in x 12ft (North), between arenas 16ft x 16ft
Canteen/Eating Area: Full service Canteen with seating between the rinks
Hockey Essentials: “Between the Rinks” skate sharpening and supplies
Washrooms: located on Mainstreet Hallways

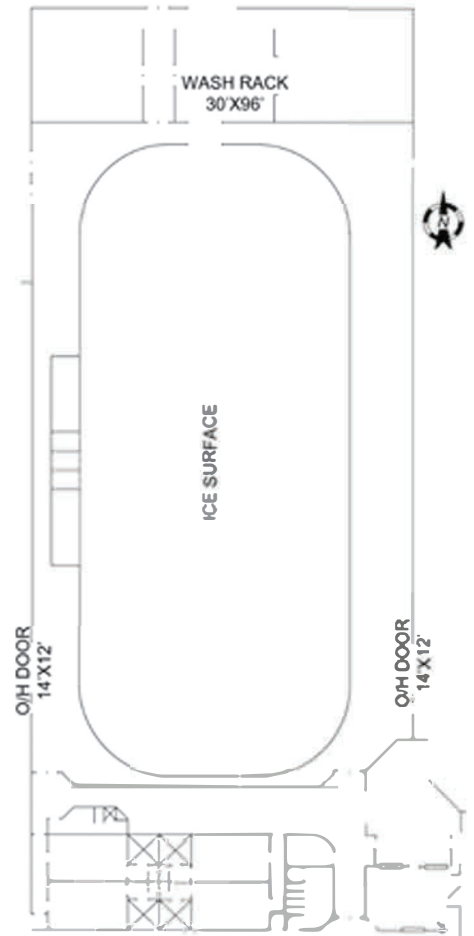

FLYNN ARENA

Room Details:

Dimensions: 120ft x 210ft (25,200 ft²)

Location: Lower level

Ceiling: 25ft

Flooring: Concrete

Entrances: Double doors (2)

Arena Specs:

Ice Rink: 85ft x 200ft

Seating Capacity: 500, retractable bleachers

Accessible Seating: Elevated platform with ramp

Dressing Rooms: 1 Referee Change Room

1 Universal Change Room

4 Full size Change Rooms with washroom and showers

Features:

Loading Overhead Door: 13ft 8in x 12ft (North), between arenas 16ft x 16ft

Canteen/Eating Area: Full service Canteen with seating between the rinks

Hockey Essentials: "Between the Rinks" skate sharpening and supplies

Washrooms: located on Mainstreet Hallways



CANADA ROOM

Room Details:

Dimensions: 120ft x 180ft (21,600 ft²)
Location: Westoba Agricultural Centre of Excellence
Ceiling: 18ft 4in
Flooring: Concrete

Convention:

Theatre Seating: 1680 approx
Banquet Seating: 800 approx
Tradeshow Booths: 115 approx (10ft x 10ft)
Entrances: Double doors (5)
Lighting: Fluorescent-row switches
Audio/Visual:
 XLR inputs (3)
 Fixed house speakers (linkable with all lower level rooms)

Agricultural Specs:

Max Stalls: 116 – 10ft x 10ft box stalls
Wash Rack: 30ft x 96ft – 18 washbays

Features:

Loading Overhead Door: 22ft x 18ft (North), 12ft x 12ft (South)
Washrooms: Men's and Women's (located in South hallway and beside Ag Centre canteen)
Office Space: 10ft x 10ft (South wall, glass windows)
Storage Room: 10ft x 11ft w/ overhead roll-up window

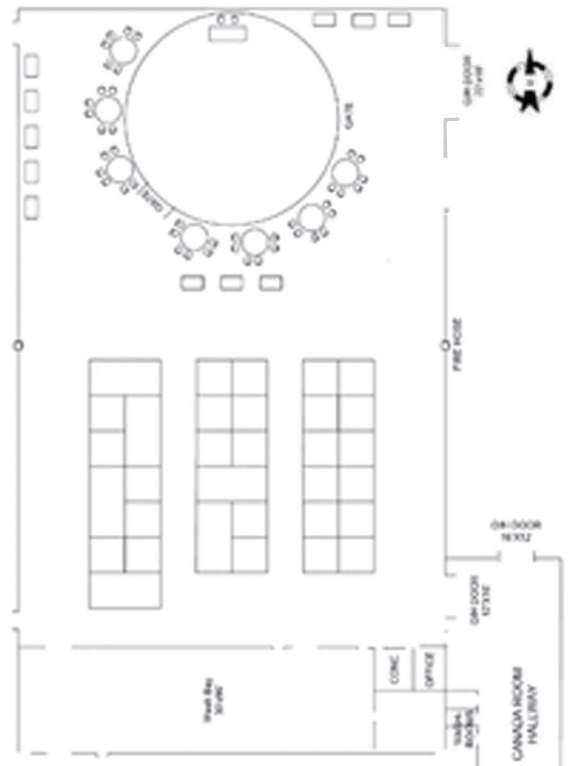

WESTOBA SHOW RING

Room Details:

Ring Size: 91ft x 200ft

Ceiling: 21ft 7in

Location: Westoba Agricultural Centre of Excellence

Loading Overhead Door: 22ft x 18ft (North / South), 16ft 5in x 14ft (Hallway)

Footing: Clay & sand mixture

Capacity: 700, bleacher seating

Convention:

112' x 242' (27,242 ft²)

Features:

Announcer Stand: Located on the west side of the Westoba Show Ring, audio connection, independent show ring announcer microphone and dedicated barn page microphone are provided.

Power: Limitations vary. Contact Ag Manager for details.



OUTDOOR SHOW RING

Ring Size: 255ft x 300ft

Footing: 2 inches of sand on top of packed shale

Announcer Stand: Enclosed announcer stand with paging capabilities to all barns and hallways

Capacity: 700, bleacher seating (additional bleachers can be brought in as requested)

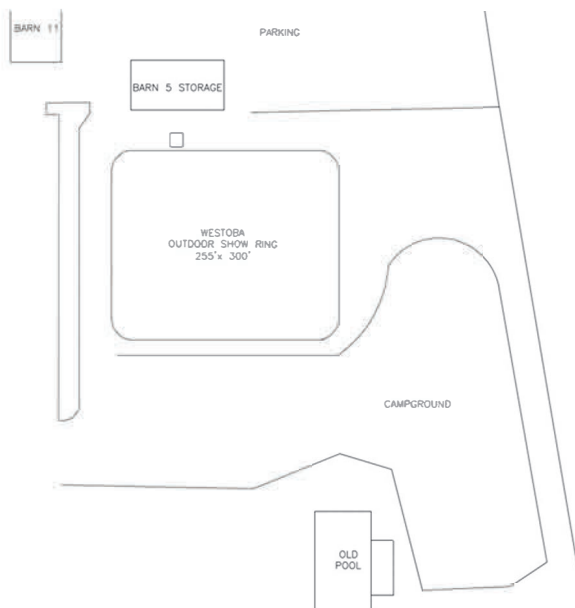

BARN 1

Room Details:

Room Size: 65ft x 150ft (9,750 ft²)

Ceiling: 17ft 6in

Loading Overhead Door: 13ft x 10ft (East), 12ft x 12ft (Hallway)

Fixed Stalls: 29 – 10ft x 10ft

Centre Stalls: 24 – 10ft x 10ft

Max. Stalls: 53

Wash Rack: 6 stall (shared with Barn 2)

Power: Limitations vary contact Ag Manager for details.

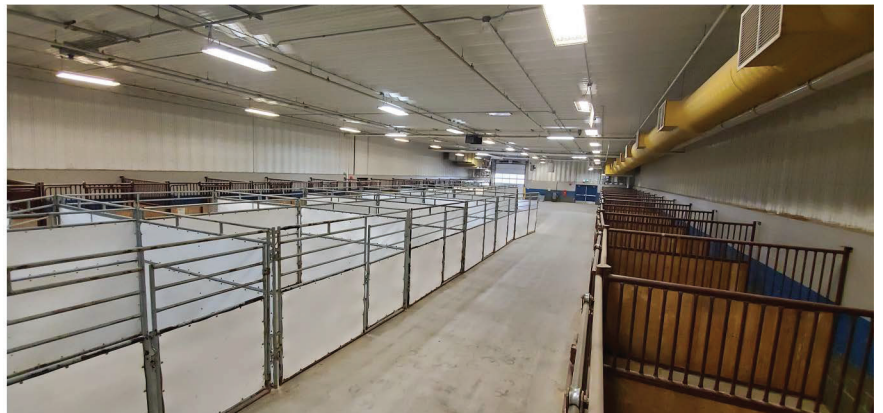
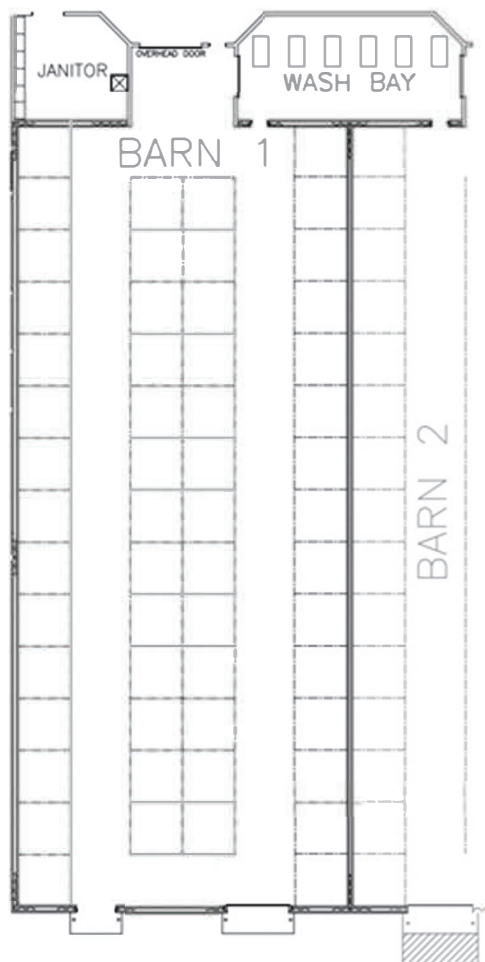

BARN 2

Room Details:

Room Size: 65ft x 150ft (9,750 ft²)

Ceiling: 17ft 6in

Loading Overhead Door: 13ft x 10ft (East), 12ft x 12ft (Hallway)

Fixed Stalls: 28 – 10ft x 10ft

Centre Stalls: 24 – 10ft x 10ft

Max. Stalls: 52

Wash Rack: 6 stall (shared with Barn 2)

Power: Limitations vary contact Ag Manager for details.

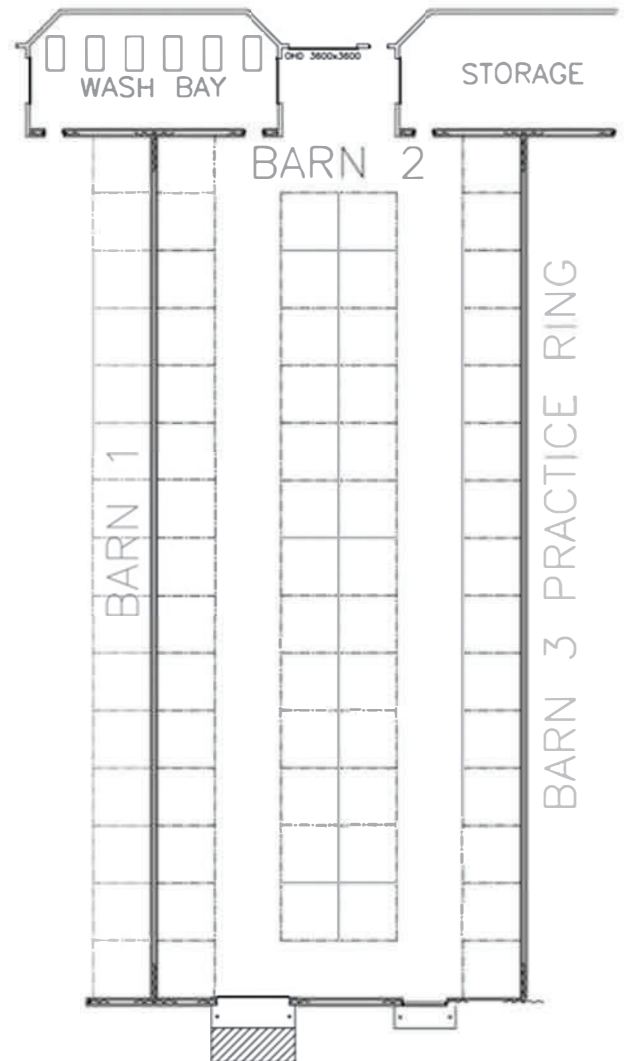
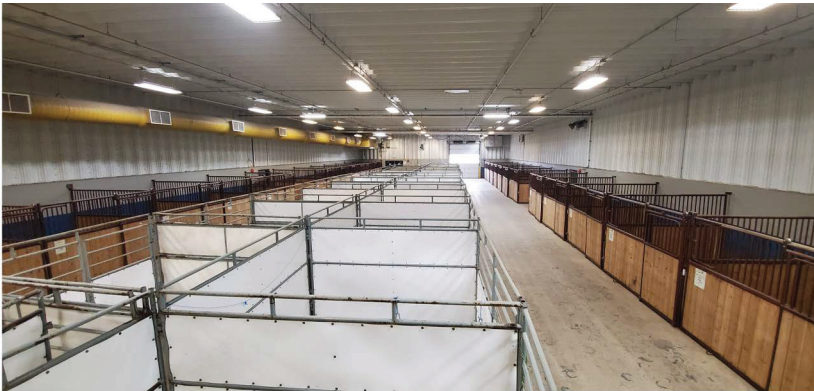

BARN 3

Room Details:

Room Size: 65ft x 150ft (9,750 ft²)

Ceiling: 17ft 6in

Loading Overhead Door: 13ft x 10ft (East), 12ft x 12ft (Hallway)

Footing: Clay and sand mixture

Centre Hi Quall: 29 – 10ft x 10ft

Wash Rack: 6 stall (shared with Barn 4)

Power: Limitations vary contact Ag Manager for details.

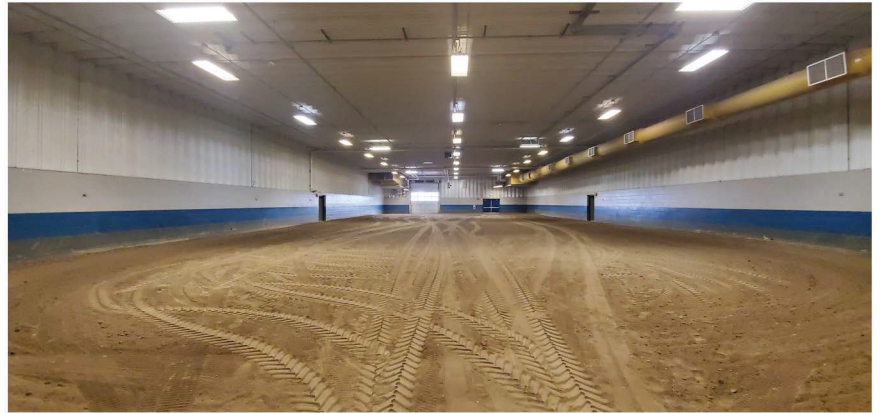
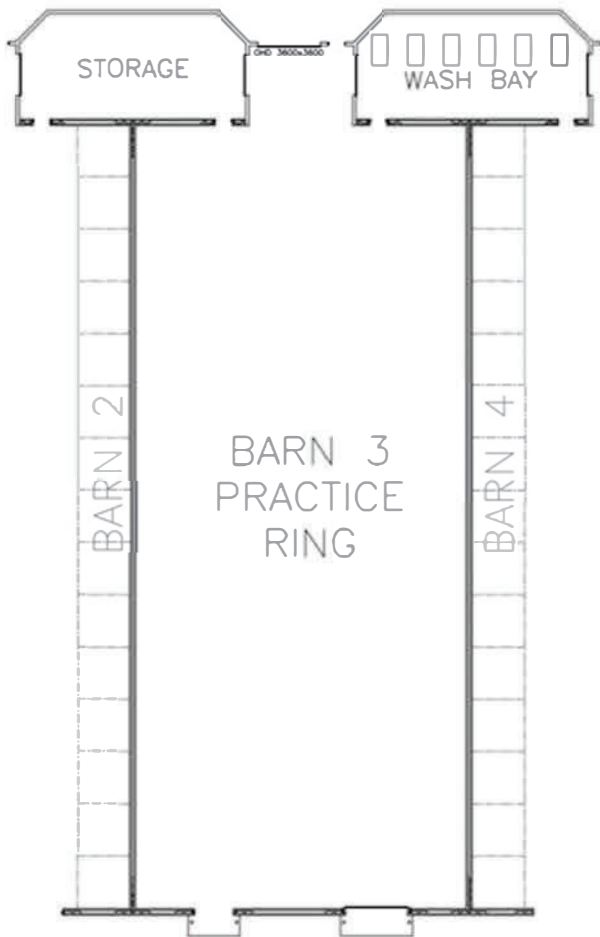

BARN 4

Room Details:

Room Size: 65ft x 150ft (9,750 ft²)

Ceiling: 17ft 6in

Loading Overhead Door: 13ft x 10ft (East), 12ft x 12ft (Hallway)

Fixed Stalls: 29 – 10ft x 10ft

Centre Stalls: 24 – 10ft x 10ft

Max. Stalls: 53

Wash Rack: 6 stall (shared with Barn 3)

Power: Limitations vary contact Ag Manager for details.

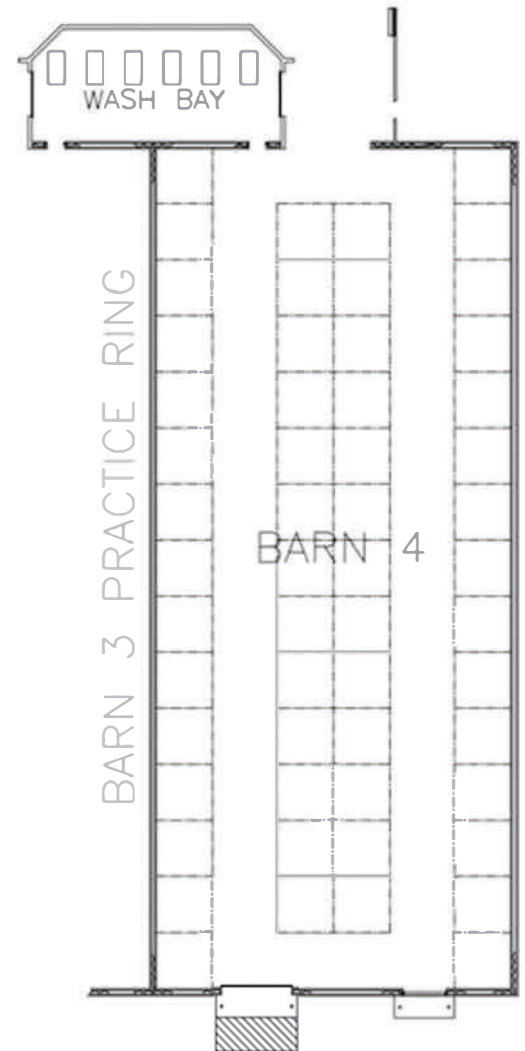

BARN 11

Room Details:

Room Size: 59ft x 103ft (6,077 ft²)

Ceiling: 12ft 4in

Loading Overhead Door: 13ft x 10ft (East), 8ft x 8ft (West to Flynn Arena)

Flooring: Concrete

Max. Stalls: 34 - 10ft x 10ft

Power: Limitations vary contact Ag Manager for details.

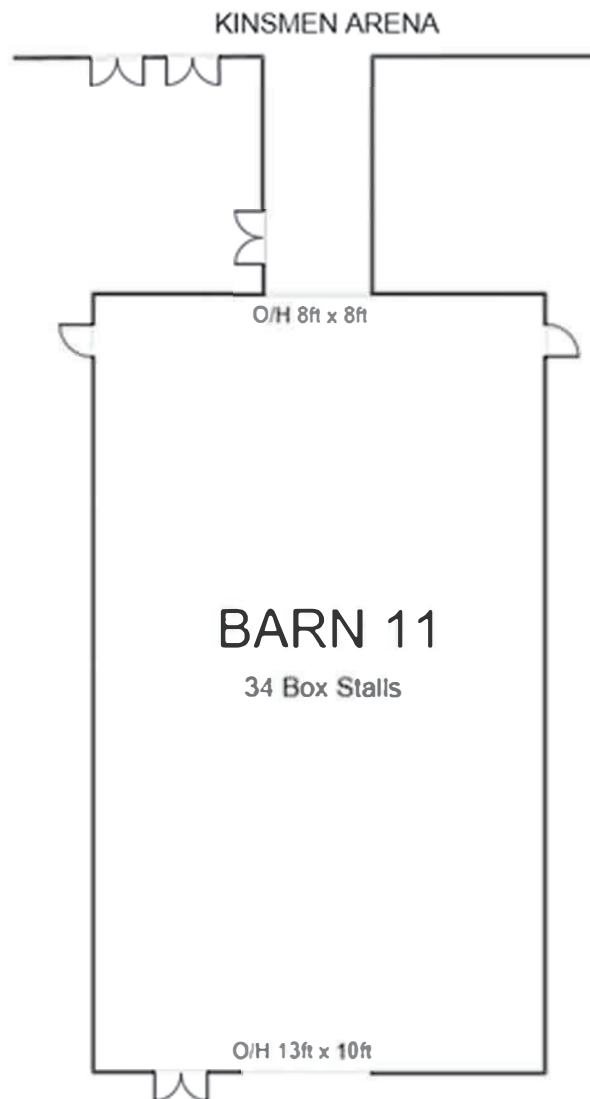

OUTDOOR STAGE AREA & EAST GRASSED LOT

Details: **Dimensions:** 540ft x 1,225ft (661,500 ft²)
Stage Size: Refer to below diagram
Location: East Grounds
Access: Queens Ave, Richmond Ave, 13th Street
Parking: Keystone Lot, Grassed Area

Features: **Clara:** Clara is a brand new, clear top reception tent located in the Patmore Forest (Keystone Centre East Grassed Lot). For more information, contact the Keystone Centre Sales Department at 204-729-3752
Power: 200AMP U.S.E, additional power can be run *additional charges apply
Water: Non-potable (available upon request)
Stage Roof: Available on request
Camping: No service campsites

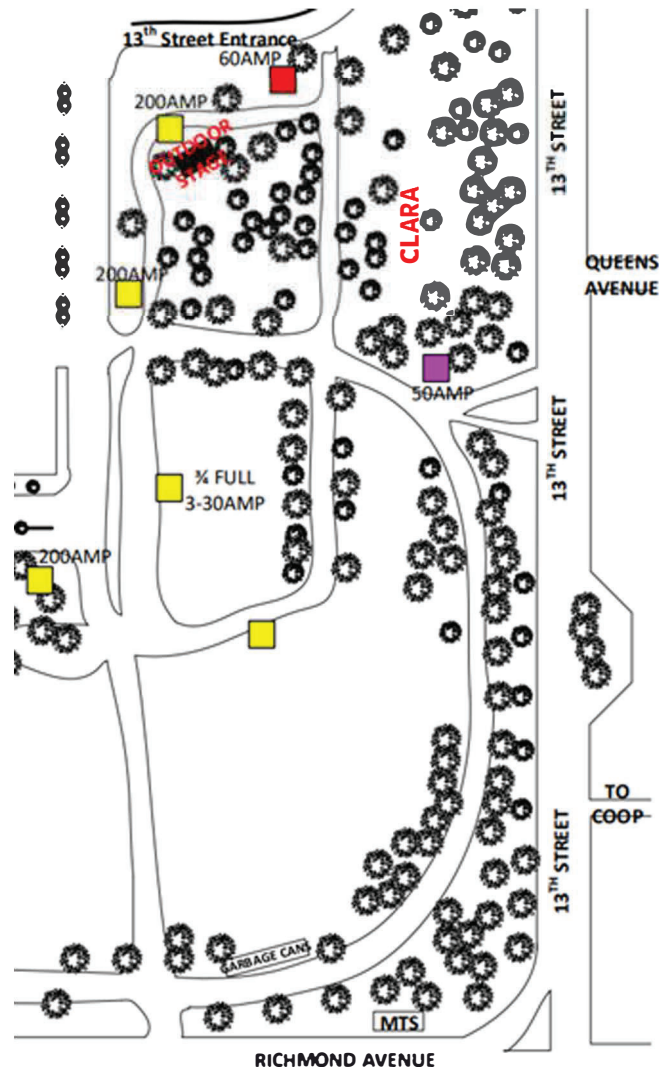

SOUTH PARKING LOT

Details:

Dimensions: 290ft x 440ft (127,440 ft²)

Location: South of Westoba Place

Access: Queens Ave, Richmond Ave, 13th Street, Canad West Parking Lot

Parking: Keystone Lot, Grassed Area

Features:

Power: 200AMP Staff Parking, 100AMP North - additional power (charges apply)

Water: Non-potable (available upon request)

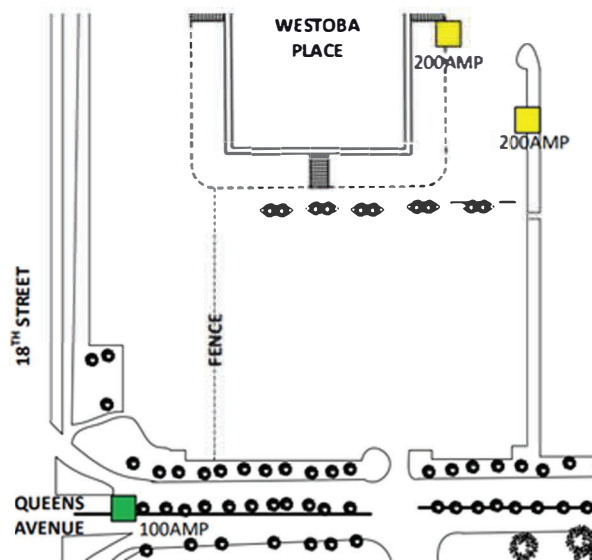

SOUTH GRASSED LOT

Details: **Dimensions:** 578ft x 879ft (508,062 ft²)
Location: South Grounds
Access: Queens Ave, Richmond Ave, 13th Street
Parking: Keystone Lot, Grassed Area

Features: **Power:** 200AMP US, additional power can be run (charges apply)
Water: Non-potable (available upon request)

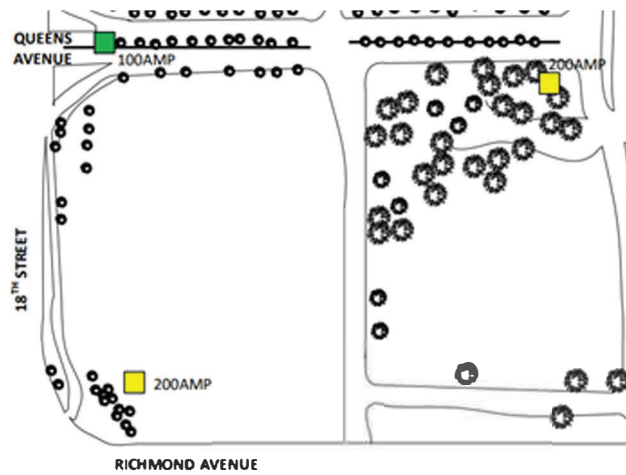

GROUNDS & PARKING LOT SPECS

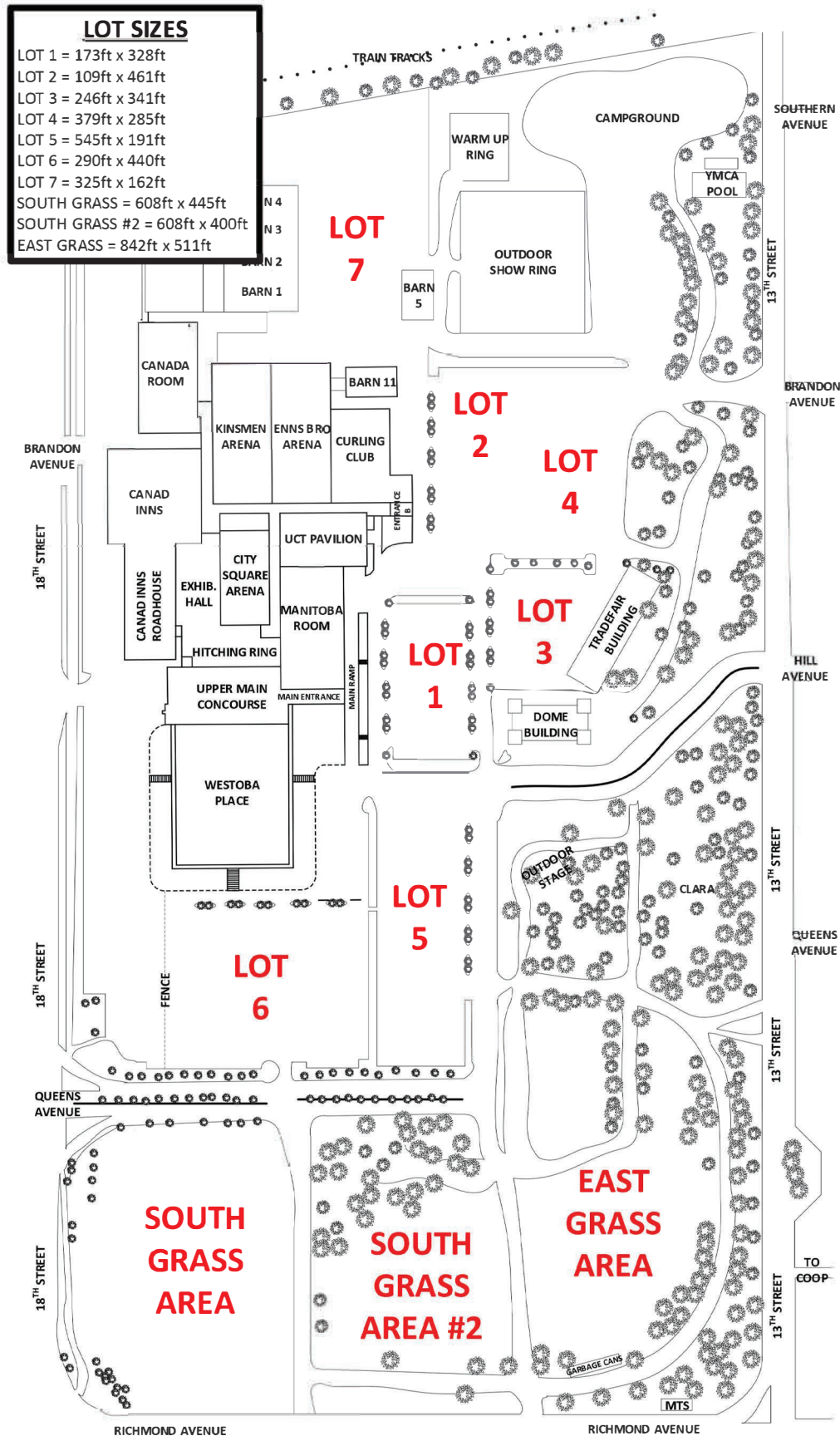

OUTDOOR ELECTRICAL

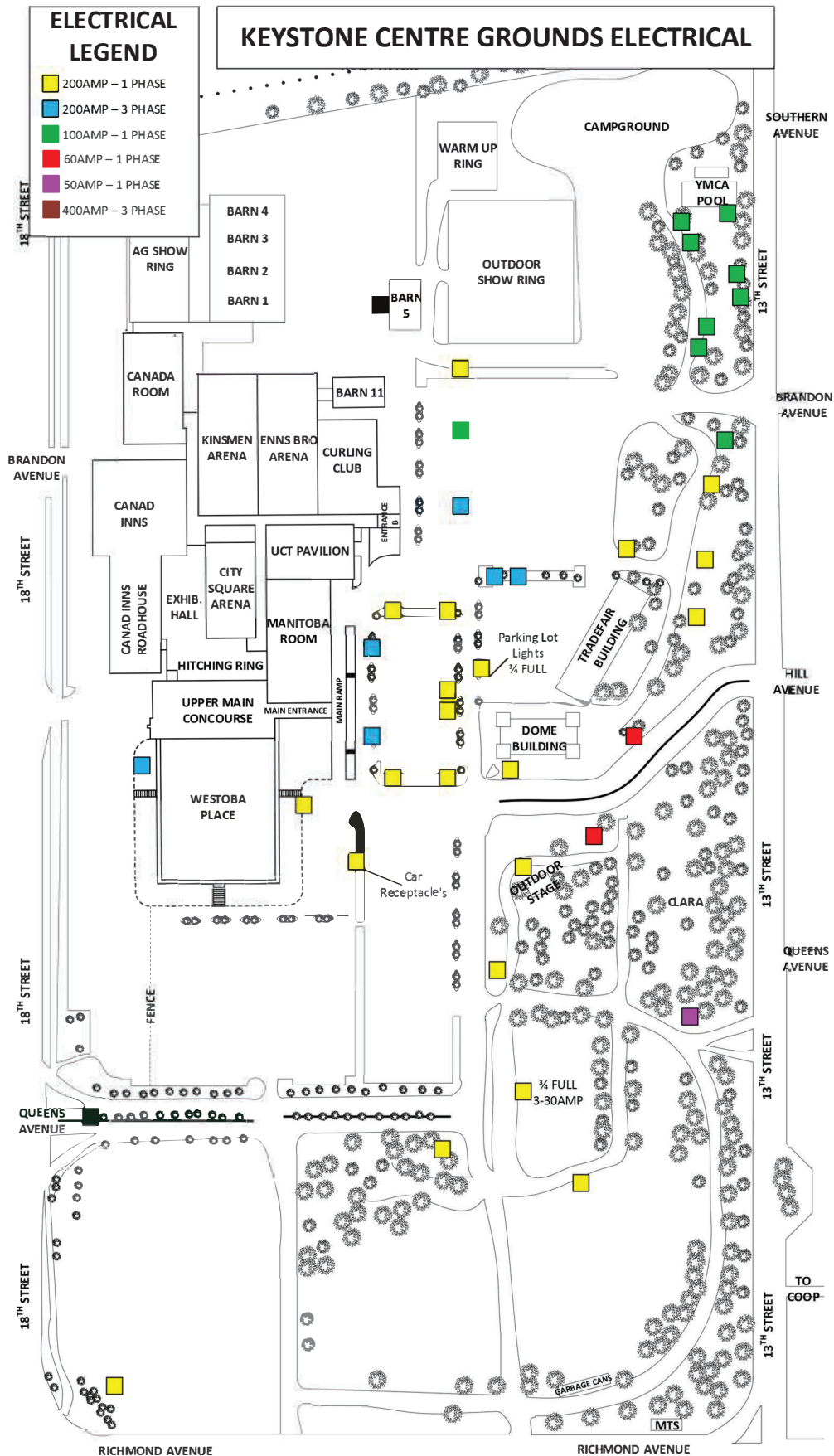

CONVENTION & TRADESHOW

<u>Chairs:</u>	Red Padded: 400 Burgundy Padded: 350 Black Plastic: 1600
<u>Tables:</u>	Plastic 8ft: 126 Wood 8ft: 150 Plastic Rounds 5ft: 65 Wood Rounds 5ft: 84 Wood Rounds 4ft: 28
<u>Linen:</u>	White and black tablecloths Assorted colored napkins
<u>Pipe & Drape:</u>	Black 16ft x 10ft Sections: 6 Burgundy 8ft x 10ft Sections: 15
<u>Audio/Visual:</u>	Podiums: 6 Wired Microphones: 4 Wireless Microphones: 8 Lapel Microphones: 1 Mixers: 4 Portable XLR Speakers: 2 pairs Portable Projectors: 2 Portable Projection Screens: 5 (4ft-10ft) Assorted Cables: HDMI, VGA, Mini display, AUX, XLR
<u>Electrical:</u>	Assorted extension cords and power bars A-frame Power Drops: 15amp receptacle
<u>Stage:</u>	Stage Deck - 8ft x 4ft x 2ft-6ft : 81 stage Stage Deck Frames - Adjustable 4ft to 6ft: - 15 frames Stage Deck Frames - Adjustable 1.5ft to 2ft - 7 frames Blue Carpet 8ft x 4ft - 18" high - 51 stage
<u>Catering:</u>	In-house: Sodexo Live!
<u>Internet & Phones:</u>	The Keystone Centre has WIFI internet throughout the building, a password will be provided to you during your event from the Sales Manager. If hard-wired internet and phone lines are required these must have a 7 day advance notice in order to avoid late fees. Please contact Sales Manager for details

Additional or alternative amenities from the list above can be discussed with the Sales Department and their trusted partners.

AGRICULTURAL

Ag Equipment: 2 – John Deer 5115M Tractors
1 – 8ft Kiser arena drag
1 – 10ft Kiser arena drag
2 – In-house forklifts
1 – In-house 30ft scissor lift

Footings: Sand & clay mixture – See Ag Manager for additional details.

Power Drops: Power drops are available. Please contact Ag Manager for details.

Tradeshow Booths: Max capacity 65 – 10ft x 10ft booths in Westoba Ag Centre hallways

Ring Workings: The Keystone Centre is a unionized building. All equipment will only be operated by authorized Keystone Centre employees.

Internet & Phones: The Keystone Centre has WIFI internet throughout the building, a password will be provided to you during your event from the Ag Manager. If hard-wired internet and phone lines are required these must have a 7 day advance notice in order to avoid late fees. Please contact Ag Manager for details.

AG CENTRE SOUND

House Sound System: The house sound system is able to provide a multitude of arrangements with barn paging and independent sound in each barn/ring. This extends to our Outdoor Show Ring as well. The system is made up of custom, full range speakers and horns strategically placed around the arena and barns. Independent sound can be provided as required – contact Ag Manager.

STALLING & STEEL

Hi Quall Stalls: 10ft x 10ft w/ sliding door - located in Barn 1, 2, 3, 4 and the Canada Room.

Stalls: 67 - 10ft x 10ft w/ swinging door – located in the center rows in Barns 1, 2, 3, 5. Ability to be set up in other event locations as required.

Heavy Horse Stalls: 5ft x 10ft – Check with Ag Manager for availability

Cattle Steel:
83 – 10ft x 10ft
92 – 8ft x 10ft

Blue Steel: 159 – 10ft panels

Range Panels: 7 - 29ft



CAMPING

Serviced Sites:

The Keystone Centre has 43 full-service on-site camping spots, as well as 32 sites equipped with electrical and water only. These sites are available to book through our website at www.keystonecentre.com

Overflow Camping:

29 additional campsites are available upon request. Additional charges apply for service.

